

WB

Washdown Base Technical Manual and User's Guide

METTLER TOLEDO is recognized around the world for manufacturing and marketing high quality scales and weighing systems. With roots tracing back to 1901, the company takes pride in its long established record of employing innovation, technology, and a close working relationship with its customers to meet the diverse needs of the global marketplace. METTLER TOLEDO's world headquarters is in Greifensee, Switzerland.

©Mettler-Toledo, Inc. 1999

No part of this manual may be reproduced or transmitted in any form or by any means, electronic or mechanical, including photocopying and recording, for any purpose without the express written permission of Mettler-Toledo, Inc.

U.S. Government Restricted Rights: This documentation is furnished with Restricted Rights.

CUSTOMER FEEDBACK

If you have a problem with this product, or just a suggestion on how we can serve you better, please fill out this form and send it to us. Your feedback will help us to improve product performance, quality and service. If you are in the United States, you can mail this postpaid form to the address on the reverse, or fax it to (614) 438-4355. If you are outside the United States, please apply the appropriate amount of postage before mailing. You may also fax it the number above.

Your Name:	Date:
Organization Name:	Mettler Toledo Order Number
Address:	Part / Product Name:
	Part / Model Number:
	Serial Number:
Phone Number: () Fax Number: ()	Company Name of Installation:
E-mail Address:	Contact Name:
	Phone Number:

How well did this product meet your expectations in its intended use? <input type="checkbox"/> Met and exceeded my needs <input type="checkbox"/> Met all needs <input type="checkbox"/> Met most needs <input type="checkbox"/> Met some needs <input type="checkbox"/> Did not meet my needs	Comments: <hr/> <hr/> <hr/> <hr/> <hr/>
---	--

PROBLEM:		
UNACCEPTABLE DELIVERY:	OUT OF BOX ERROR:	
<input type="checkbox"/> Shipped late	<input type="checkbox"/> Wrong item	<input type="checkbox"/> Wrong documentation
<input type="checkbox"/> Shipped early	<input type="checkbox"/> Wrong part	<input type="checkbox"/> Missing documentation
<input type="checkbox"/> Shipped to incorrect location	<input type="checkbox"/> Missing equipment	<input type="checkbox"/> Incorrectly calibrated
<input type="checkbox"/> Other (Please Specify)	<input type="checkbox"/> Equipment failure	<input type="checkbox"/> Other (Please specify)
Comments: <hr/> <hr/> <hr/>		

<i>DO NOT WRITE IN SPACE BELOW; FOR METTLER TOLEDO USE ONLY</i>			
<input type="checkbox"/> Retail	<input type="checkbox"/> Light Industrial	<input type="checkbox"/> Heavy Industrial	<input type="checkbox"/> Systems
RESPONSE: Include Root Cause Analysis and Corrective Action Taken. <hr/> <hr/>			

FOLD THIS FLAP FIRST



NO POSTAGE
NECESSARY IF
MAILED IN THE
UNITED STATES

BUSINESS REPLY MAIL
FIRST CLASS PERMIT NO. 414 COLUMBUS, OH

POSTAGE WILL BE PAID BY ADDRESSEE

Mettler-Toledo, Inc.
Quality Manager - MTWI
P.O. Box 1705
Columbus, OH 43216
USA

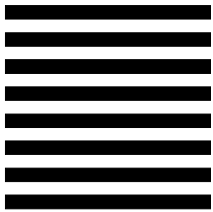

Please seal with tape.

INTRODUCTION

Information regarding METTLER TOLEDO Technical Training may be obtained by writing to:

METTLER TOLEDO
1900 Polaris Parkway
Columbus, Ohio 43240
(614) 438-4511

FCC Notice

This device complies with Part 15 of the FCC Rules and the Radio Interference Requirements of the Canadian Department of Communications. Operation is subject to the following conditions: (1) this device may not cause harmful interference, and (2) this device must accept any interference received, including interference that may cause undesired operation.

This equipment has been tested and found to comply with the limits for a Class A digital device, pursuant to Part 15 of FCC Rules. These limits are designed to provide reasonable protection against harmful interference when the equipment is operated in a commercial environment. This equipment generates, uses, and can radiate radio frequency energy and, if not installed and used in accordance with the instruction manual, may cause harmful interference to radio communications. Operation of this equipment in a residential area is likely to cause harmful interference in which case the user will be required to correct the interference at his own expense.

METTLER TOLEDO RESERVES THE RIGHT TO MAKE REFINEMENTS OR CHANGES WITHOUT NOTICE.

PRECAUTIONS

READ this manual BEFORE operating or servicing this equipment.

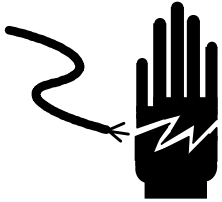
	⚠ WARNING
	ONLY PERMIT QUALIFIED PERSONNEL TO SERVICE THIS EQUIPMENT. EXERCISE CARE WHEN MAKING CHECKS, TESTS AND ADJUSTMENTS THAT MUST BE MADE WITH POWER ON. FAILING TO OBSERVE THESE PRECAUTIONS CAN RESULT IN BODILY HARM.

FOLLOW these instructions carefully.

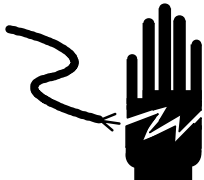
	⚠ WARNING
	DISCONNECT ALL POWER TO THIS UNIT BEFORE SERVICING.

SAVE this manual for future reference.

⚠ CAUTION	
BEFORE CONNECTING/DISCONNECTING ANY INTERNAL ELECTRONIC COMPONENTS OR INTERCONNECTING WIRING BETWEEN ELECTRONIC EQUIPMENT ALWAYS REMOVE POWER AND WAIT AT LEAST THIRTY (30) SECONDS BEFORE ANY CONNECTIONS OR DISCONNECTIONS ARE MADE. FAILURE TO OBSERVE THESE PRECAUTIONS COULD RESULT IN DAMAGE TO OR DESTRUCTION OF THE EQUIPMENT OR BODILY HARM.	

DO NOT allow untrained personnel to operate, clean, inspect, maintain, service, or tamper with this equipment.

⚠ CAUTION	
OBSERVE PRECAUTIONS FOR HANDLING ELECTROSTATIC SENSITIVE DEVICES.	

ALWAYS DISCONNECT this equipment from the power source before cleaning or performing maintenance.

	⚠ WARNING!
	IF YOU PLAN TO USE A WB BASE IN A HAZARDOUS ENVIRONMENT, THE FACTORY NUMBER MUST HAVE AN "X" IMMEDIATELY FOLLOWING THE CAPACITY. ALL OTHER MODELS ARE NOT APPROVED FOR HAZARDOUS ENVIRONMENTS. THE WB06X, WB15X, WB30X, WB60X, WB75X, AND WB150X ARE APPROVED FOR USE IN HAZARDOUS ENVIRONMENTS ONLY WHEN USED IN CONJUNCTION WITH AND INSTALLED PER THE APPROPRIATE INSTALLATION (CONTROL) DRAWING(S). ANY MODIFICATION TO THESE DRAWINGS WILL VOID AGENCY APPROVAL AND COULD PRODUCE A HAZARDOUS CONDITION.

CALL METTLER TOLEDO for parts, information, and service.

CONTENTS

1	Introduction	1-1
	Model Identification.....	1-1
	Indicator/Terminal Compatibility	1-2
2	Installation.....	2-1
	Preparation.....	2-1
	Inspection and Setup	2-1
	Selecting the Location	2-2
	Level the Base.....	2-2
	Wiring Connections	2-2
	Calibration.....	2-3
3	Operating Instructions	3-1
4	Service and Maintenance.....	4-1
	Cleaning and Maintenance	4-1
	Maintenance Reminders	4-1
	Load Cell Replacement.....	4-1
5	Additional Information	5-1
	Weights and Measures Approval.....	5-1
	Standard Features.....	5-1
	Hazardous Environments.....	5-1
	Factory Mutual	5-2
	CSA	5-2
6	Parts and Accessories	6-1
	Small Washdown Base (WB06)	6-2
	Medium Washdown Base (WB15, WB30, WB60)	6-4
	WB Large Base (WB75 and WB150)	6-6

1

Introduction

The WB washdown base is a 100% stainless steel scale base designed for industrial and commercial applications in light washdown environments. Models are also available for use in hazardous areas. The WB scale base can be connected with a variety of METTLER TOLEDO terminals, providing maximum flexibility for customizing a system.

This manual provides information for installing, adjusting, and trouble-shooting the WB scale base. Additional information may be found in the manual(s) for the terminals which you are connecting to the WB scale base.

If you discover a problem with the information provided in this manual, please complete and fax the **Publication Evaluation Form** found in the back of this manual. For problems not covered in this manual, please contact your authorized METTLER TOLEDO representative.

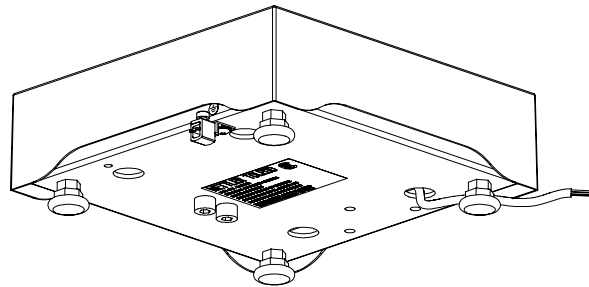

Model Identification

The WB scale base is available in six capacities and three sizes. Refer to the example and chart that follow to identify the WB base model with which you are working. Refer to Chapter 5 for additional information on hazardous area approvals.

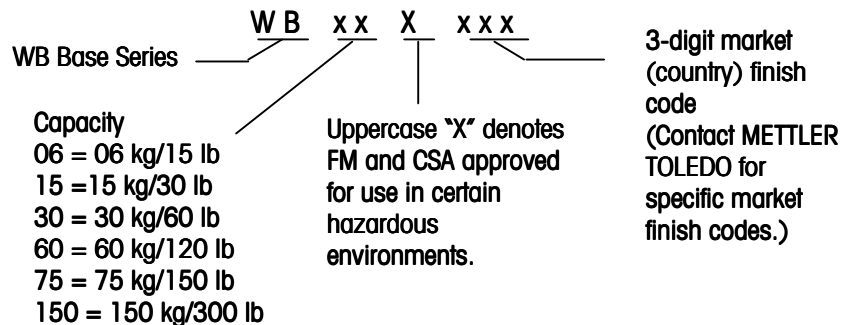

Example:

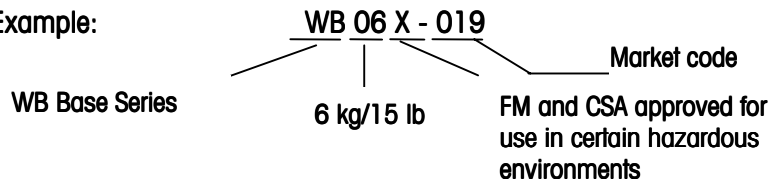

Model Numbers and Specifications

Specifications	WB06	WB15	WB30	WB60	WB75	WB150
Maximum Capacity	6 kg/ 15 lb	15 kg/ 30 lb	30 kg/ 60 lb	60 kg/ 120 lb	75 kg/ 150 lb	150 kg/ 300 lb
Minimum Division Size	0.001 kg/ 0.002 lb	0.002 kg/ 0.005 lb	0.005 kg/ 0.01 lb	0.01 kg/ 0.02 lb	0.01 kg/ 0.02 lb	0.02 kg/ 0.05 lb
Recommended Build*	5 x 0.001 kg/ 10 x 0.002 lb	10 x 0.002 kg/ 25 x 0.005 lb	25 x 0.005 kg/ 50 x 0.01 lb	50 x 0.01 kg/ 100 x 0.02 lb	50 x 0.01 kg/ 100 x 0.02 lb	100 x 0.02 kg/ 250 x 0.05 lb
Load Cell Capacity	11 kg	22 kg	45 kg	100 kg	100 kg	200 kg
Dimensions (W x D x H)	230 x 230 x 80 mm 9 x 9 x 3 in	305 x 305 x 80 mm 12 x 12 x 3 in			455 x 455 x 105 mm 18 x 18 x 4 in	
Shipping Weight	7 kg / 16 lb	11 kg / 24 lb			27 kg / 59 lb	
Load Cell Cable Length	2 m / 6 ft				3 m / 10 ft	
Load Cell Type	Analog - single 350 ohm load cell					
Compatible METTLER TOLEDO Products	PANTHER®, LYNX®, JAGUAR®, ID7 (with analog scale card) LYNXBATCH®, SC Counting Scale (2 nd analog scale kit required), PUMA®					
Operating Temperature	14°F - 113°F (-10°C - 40°C) at 10% - 95% humidity, non-condensing					
Storage Temperature	-40°F - 140°F (-40°C - 60°C) at 10%-95% humidity, non-condensing					
Construction	Stainless Steel (304)					

*Allowable back weight can be calculated by subtracting the calibrated capacity from the maximum capacity.

Indicator/Terminal Compatibility

The WB base can be used with the following METTLER TOLEDO terminals and counting scales:

- PUMA® Terminal (Refer to Chapter 5, Hazardous Environments)
- JAGUAR® Terminal
- LYNX® Terminal
- PANTHER® (analog) Terminal
- LYNXBATCH® Batching Controller
- PANTHER® PLUS (Analog) Terminal
- SC Counting Scale (with analog second scale kit)
- ID7 Terminal (with analog scale kit)
- HAWK™ Terminal

2

Installation

Preparation

The WB base is a scale base only and does not include a terminal. Accessories are shipped separately. Verify that the required accessories are available before unpacking and installing the base.

The WB base should remain in its shipping carton until it reaches the location where it is to be installed for maximum protection during transit.

Inspection and Setup

Regardless of the WB base with which you will be working, the following general instructions apply in terms of unpacking and assembling the scale base:

- If the shipping container showed signs of damage at delivery, file a freight claim with the carrier if necessary.
- If you have not already done so, remove the scale base, along with its protective covering, from the shipping carton.
- Remove the protective covering, using care not to drop the WB base. Store the packaging and carton for future use should you need to transport or ship the WB base.
- Inspect the WB base for damage. Never install a WB base if damage is apparent.
- Make sure all components are included. The WB scale base should contain:
 - Weighing platform with stainless steel platter and level bubble.
 - WB Base Technical Manual and User's Guide

Contact your authorized METTLER TOLEDO representative if the WB base is damaged or any parts are missing.

	WARNING!
	<p>IF YOU PLAN TO USE A WB BASE IN A HAZARDOUS ENVIRONMENT, THE FACTORY NUMBER MUST HAVE AN "X" IMMEDIATELY FOLLOWING THE CAPACITY. ALL OTHER MODELS ARE NOT APPROVED FOR HAZARDOUS ENVIRONMENTS. THE WB06X, WB15X, WB30X, WB60X, WB75X, AND WB150X ARE APPROVED FOR USE IN HAZARDOUS ENVIRONMENTS ONLY WHEN USED IN CONJUNCTION WITH AND INSTALLED PER THE APPROPRIATE INSTALLATION (CONTROL) DRAWING(S). ANY MODIFICATION TO THESE DRAWINGS WILL VOID AGENCY APPROVAL AND COULD PRODUCE A HAZARDOUS CONDITION.</p>

Selecting the Location

For optimum weighing performance and safety, please keep the following in mind when selecting a location for the WB scale base:

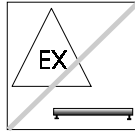

Never operate the WB base in a hazardous environment unless using one specifically approved for use in hazardous environments. A WB scale base approved for use in certain hazardous environments will have a letter "X" in the factory number. Refer to Chapter 5.

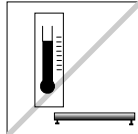

Maintain a temperature range of -10°C to 40°C (-18°F to 104°F). Avoid areas where the temperature is rapidly changing.

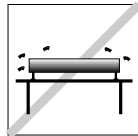

Select a firm, level, and vibration-free surface on which to place the WB scale base.

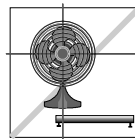

Avoid excessive drafts, such as from fans and open windows.

Level the Base

Once the WB scale base is in place, level it by performing these steps:

- Turn the leveling feet of the weighing platform until the scale is horizontal. The leveling feet should each touch the surface on which the WB scale base is placed, and the WB scale base should not rock or teeter.
- Check to make sure the level bubble (located on the top of the base underneath the platter) is centered as shown here.

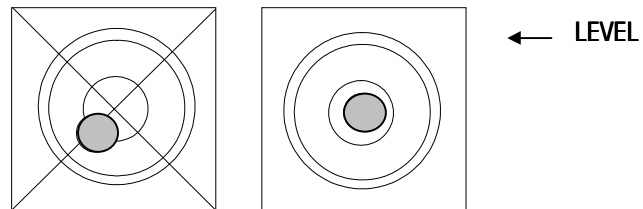

- You must re-level the WB base after every location change.

Wiring Connections

To connect the WB base to a terminal, please refer to the technical manual provided with the specific terminal with which you are working, as well as the wiring charts below for the METTLER TOLEDO PUMA[®] terminal, JAGUAR[®] terminal, LYNX[®] terminal, PANTHER[®] (analog) terminal, LYNXBATCH[®] batching

controller, PANTHER[®] PLUS (analog) terminal, HAWK[®] terminal, ID7 terminal, and SC Counting Scale (with analog second scale kit).

<u>CABLE MARKED</u>	<u>SIGNAL DESCRIPTION</u>
+OUT : GRN	+Signal Output
-OUT : BLK	-Signal Output
+IN : WHT	+Excitation Input
+SEN : YEL	+Sense Output
-SEN : RED	-Sense Output
-IN : BLU	-Excitation Input
GND : SHIELD	Cable Shield (Tied to chassis)

Calibration

Refer to the calibration procedure outlined in the technical manual for the terminal you are using.

To guarantee reliable service from the WB base, a regular calibration schedule should be implemented. In addition, the base should always be calibrated after repairs of any type are performed. Contact your authorized METTLER TOLEDO representative for more information.

NOTES

3

Operating Instructions

The operating instructions for the WB base depend on the terminal with which it is used, as well as on the specific application for which it is being used. Refer to the operating instructions or technical manual for the terminal being used with the WB base.

However, the following general instructions should be followed for all applications and terminals to ensure the best weighing performance for the scale.

Location.

- The WB base should be placed on a solid surface that is free of excessive vibration and in an area free of drafts and sudden temperature changes.
- The area should be clear of cables, boxes, or anything else that could come in contact with the scale platter.

Accuracy.

For optimum weighing performance, place objects to be weighed towards the center of the platform.

Calibration.

Contact your authorized METTLER TOLEDO representative to arrange scheduled calibration visits by factory-trained service technicians. You may also purchase certified weights from METTLER TOLEDO to perform your own calibration checks.

Shock Loads.

The WB base is designed to withstand overload conditions up to 150% capacity without affecting the scale's weighing performance. However, comparable weights dropped from a distance on to the weighing platter may cause forces far higher than the acceptable overload capacity and damage the WB scale base's internal components or affect its accuracy. Avoid dropping excessive weight onto the platter.

Large Temperature Fluctuations.

When connected to a METTLER TOLEDO terminal, the WB base automatically compensates for normal changes in ambient temperature. If the scale base is used in areas where large or fast temperature changes occur, weighing accuracy may be affected. In these situations, wait approximately 30 minutes to allow the WB base to adjust to temperature changes before weighing anything.

Weighing Practices.



- Avoid sliding heavy items across the platter to help prevent scuffing.
- Always use proper lifting devices and practices for loading and unloading the scale. Avoid moving heavy items to the edge of the platter to get a better grip for lifting. Edge loading can tip the platter and lead to personal injury.
- When using the Tare function to remove a container's weight from the total weight on the scale, tare each container separately. Variations in materials thickness and other factors can affect the containers' weight.

4

Service and Maintenance

Cleaning and Maintenance

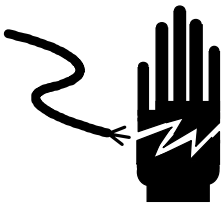
The WB base is designed for use in a light washdown environment. The scale may be washed down with water or foaming agents. Do not submerge the base in water or cleaning agents. Do not clean it with high pressure, hose-directed water.

	 WARNING
	ONLY PERMIT QUALIFIED PERSONNEL TO PROGRAM METTLER TOLEDO EQUIPMENT. EXERCISE CARE WHEN CREATING PROGRAMS OR MAKING PROGRAM CHANGES WHEN OUTPUTS ARE CONNECTED TO EXTERNAL EQUIPMENT. FAILURE TO OBSERVE THESE PRECAUTIONS CAN RESULT IN BODILY HARM AND/OR PROPERTY DAMAGE.

Maintenance Reminders

Calibration tests should be performed any time major mechanical components are replaced or adjusted. The WB base must be re-leveled after any move.

Load Cell Replacement

- Replace the rubber load cell boot if damaged.
- Note the location of spacers and adapter block during removal of the load cell. See figure 4-1.

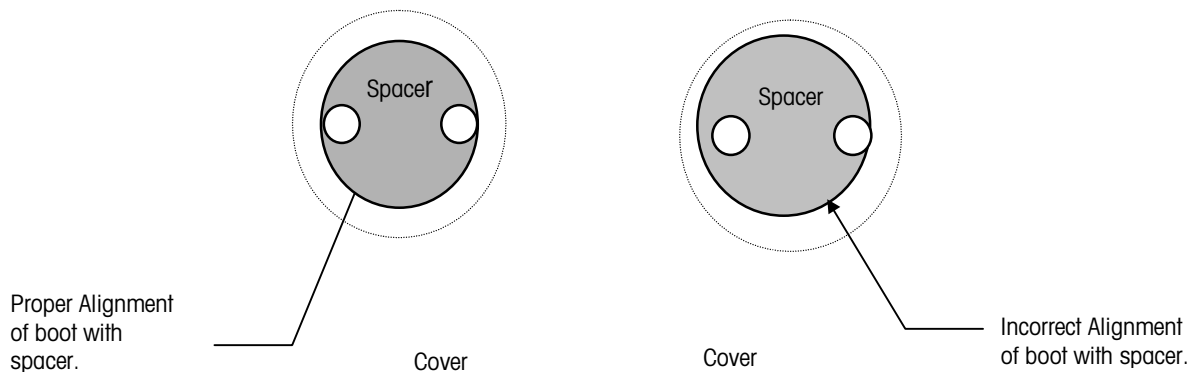

Figure 4-1

- Torque the load cell mounting bolts to 150 in-lbs (16.9 N-m) for WB06, WB15, WB30, and WB60 or 125 in-lb (14.1 N-m) for WB75 and WB150.
- Set the overload stops per the following table:

Model	Inside (2)	Outside (4)	Load Cell Bolt Torque
WB06	0.016 in. (0.406 mm)	0.065 in. (1.651 mm)	150 in-lb 16.9 N-m
WB15	0.023 in. (0.584 mm)	0.058 in. (1.473 mm)	
WB30	0.038 in. (0.965 mm)	0.108 in. (2.743 mm)	
WB60	0.064 in. (1.625 mm)	0.181 in. (4.597 mm)	
WB75	0.025 in 0.635 mm	0.115 in 2.921 mm	125 in-lb 14.1 N-m
WB150	0.050 in 1.27 mm	0.210 in 5.33 mm	

Overload stops should be set to a tolerance of ± 0.003 in (0.08 mm)

5

Additional Information

Weights and Measures Approval



The WB scale base is in compliance with OIML Class III standards and is designed to meet or exceed the National Institute of Standards (NIST) Handbook 44 requirements for 5000d. A certificate of conformance 98-109 was issued under the National Type Evaluation Program (NTEP) of the National Conference on Weights and Measure.

The WB scale base meets and/or exceeds the Canadian Weights and Measures Laboratories (in Canada) requirements for Class III, 5000d rating. Approval AM-5259 was issued by statutory authority of the Minister of Industry, Science and Technology of Canada.

Standard Features

All WB scale bases are manufactured from 100% stainless steel. The length of the load cell cables for the WB06, WB15, WB30, and WB60 is six feet (two meters). The length of the load cell cables for the WB75 and WB150 is ten feet (three meters).

Hazardous Environments

	 WARNING!
	<p>THE WB-X BASES ARE APPROVED FOR USE IN HAZARDOUS ENVIRONMENTS <u>ONLY</u> WHEN USED IN CONJUNCTION WITH AND INSTALLED PER THE APPROPRIATE INSTALLATION (CONTROL) DRAWING(S). REFER TO THE TECHNICAL MANUAL SUPPLIED WITH THE MATING TERMINAL FOR DETAILS. DO NOT SUBSTITUTE OR MODIFY ANY ITEMS ON THESE CONTROL DRAWINGS. ANY MODIFICATION WILL VOID AGENCY APPROVAL AND COULD PRODUCE A HAZARDOUS CONDITION.</p>

Factory Mutual

The load cells used in models WB06X-000, WB15X-000, WB30X-000, WB60X-000, WB75X-000 and WB150X-000 have been approved by Factory Mutual and are listed in METTLER TOLEDO document 122502 for use in Class I, II, III Division 1&2 Groups A,B,C,D,E,F, and G Classified locations. This model number will appear as the factory number on the data plate. If the factory number does not have an "X" immediately following the two-digit capacity, contact your authorized METTLER TOLEDO representative.

The WB-X bases are only approved for use with specific instruments that have been approved by Factory Mutual. Refer to the technical manual provided with the instrument for the Control Drawing containing installation and wiring details.

CSA

The models WB06X-019, WB15X-019, WB30X-019, and WB60X-019 have been approved by CSA and are listed on METTLER TOLEDO document 156305R for use in Class I Division 1 & 2 Groups A, B, C, and D Classified locations. This number will appear as the factory number on the data plate. If the factory number does not have an "X" immediately following the two-digit capacity, contact your authorized METTLER TOLEDO representative.

The WB75X-019 and WB150X-019 have been submitted to CSA for their approval for use in areas classified as Class I Division 1 and 2 Groups A, B, C, and D.

The WB-X bases are only approved for use with specific instruments that have been approved by CSA. Refer to the technical manual provided with the instrument for the Control Drawing containing installation and wiring details.

A safety ground must be installed per Canadian Electrical Code 22.1 Appendix F3.2. The safety ground lug extends from the side of the base as shown in the following diagram.

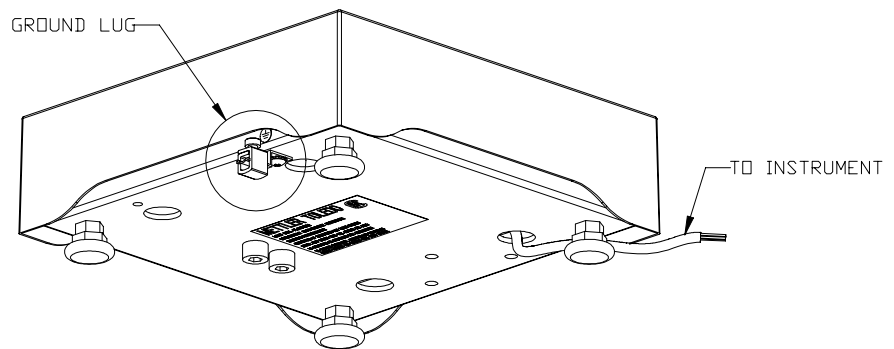

6

Parts and Accessories

Please refer to the drawings and parts lists on the following pages.

Small Washdown Base (WB06)

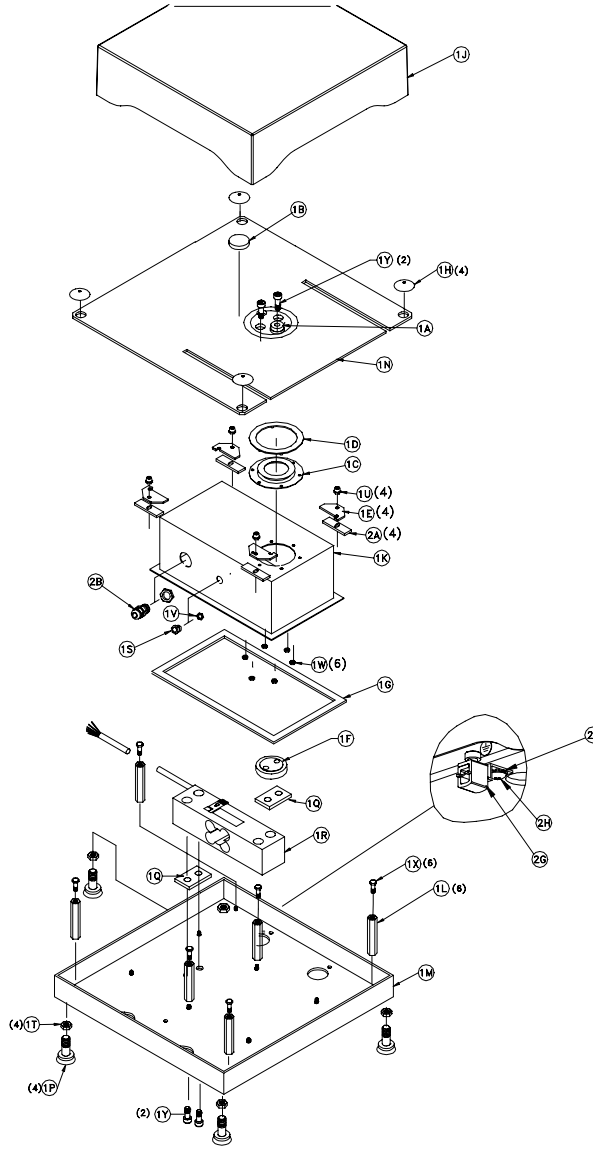

Parts List – Small Washdown Base Assembly			
Ref. #	Part Number	Description	Qty
1A	(*)10268900A	Level	1
1B	(*) 10839700A	Pad, Damper	1
1C	(*)13937600A	Boot, Load Cell	1
1D	(*)15330100A	Clamp, Boot Ring	1
1E	(*)15219600A	Bracket, Hold Down	4
1F	(*)15349800A	Adaptor Block, Boot	1
1G	(*)15219700A	Gasket, L/C Enclosure	1
1H	(*)14044100A	Pad, Bumper	4
1J	(*)15185700A	Platter, 9", No LIP	1
1K	(*)15185300A	Enclosure, L/C	1
1L	(*)15185500A	Standoff, 10-32	6
1M	(*)15186700A	Base Weldment, 9"	1
1N	(*)15186800A	Sub-platter, 9"	1
1P	(*)12900400A	Foot, Adjusting, 5/16 – 18	4
1Q	(*)14647700A	Spacer, L/C, 1.5 x 1.0	2
1R	(*)15187200A	Load Cell 11 kg (WB06)	1
	(*)15579200A	Load Cell 11 kg FM/CSA Approved (WB06X)	
1S	(*)15473000A	Vent, Breather	1
1T	R0365600A	Nut, Hex 5/16 – 18	4
1U	R05429100A	Acorn Nut, 10-32	4
1V	R0542300A	Nut, 1/8 – Pipe	1
1W	R0509500A	Nut, Lock 4-40	6
1X	R0518100A	Screw, 10 – 32 x 5/8 trimmed	1
1Y	R0540800A	Hole Plug, PG7	4
2A	(*)15419800A	Spacer, 1.50 x 43	4
2B	(*)12901800A	Grip Busing	1
2G**	09870100A	Ground Lug	1
2H**	R0357700A	Screw, 10-32x1/2	1
2J**	R0546600A	Lock Washer, #10	1

(*)May have a letter prefix

** CSA approved models only.

Medium Washdown Base (WB15, WB30, WB60)

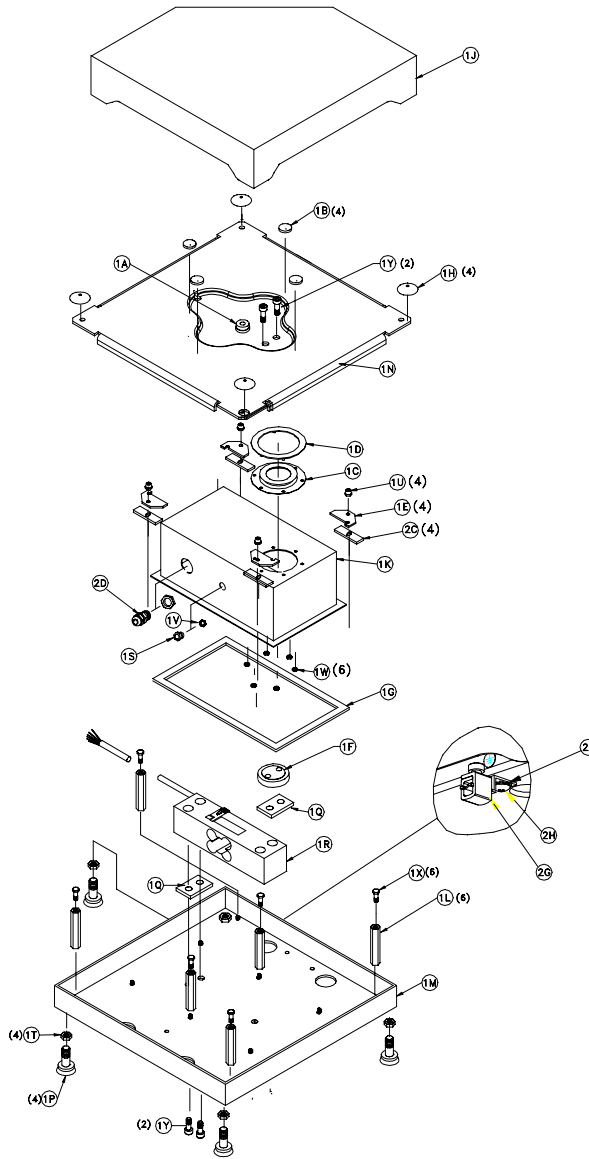

Chapter 6: Parts and Accessories
Medium Washdown Base (WB15, WB30, WB60)

Parts List – Medium Washdown Base Assembly			
Ref. #	Part Number	Description	Qty
1A	(*)10268900A	Level	1
1B	(*) 10839700A	Foot, Polyurethane, Adhesive Back	4
1C	(*)13937600A	Boot, Load Cell	1
1D	(*)15330100A	Clamp, Boot Ring	1
1E	(*)15219600A	Bracket, Hold Down	4
1F	(*)15349800A	Adaptor Block, Boot	1
1G	(*)15219700A	Gasket, L/C Enclosure	1
1H	(*)14044100A	Pad, Bumper	4
1J	(*)15185200A	Platter, 12", No LIP	1
1K	(*)15185300A	Enclosure, Load Cell	1
1L	(*)15185500A	Standoff, 10-32	6
1M	(*)15187000A	Base Weldment, 12"	1
1N	(*)15219200A	Sub-platter, 12"	1
1P	(*)12900400A	Foot, Adjusting 5/16 – 18	4
1Q	(*)14647700A	Spacer, L/C, 1.5 x 1.0	2
1R	(*)14612300A	Load Cell 22 kg (WB15)	1
	(*)15180900A	Load Cell 22 kg, FM/CSA Approved (WB15X)	
	(*)14611500A	Load Cell 45 kg (WB30)	
	(*)15181000A	Load Cell 45 kg, FM/CSA Approved (WB30X)	
	(*)14611900A	Load Cell 100 kg (WB60)	
	(*)15181100A	Load Cell 100 kg, FM/CSA Approved (WB60X)	
1S	(*)15473000A	Vent, Breather	1
1T	R0365600A	Nut, Hex 5/16 – 18	4
1U	R05429100A	Acorn Nut, 10-32	4
1V	R0542300A	Nut, 1/8 – Pipe	1
1W	R0509500A	Nut, Lock 4-40	6
1X	R0518100A	Screw, 10 – 32 x 5/8 trimmed	1
1Y	R0540800A	Hole Plug, PG7	4
2C	(*)15419800A	Spacer, 1.50 x .43	4
2D	(*)12901800A	Grip Bushing with nut	1
2G**	09870100A	Ground Lug	1
2H**	R0357700A	Screw, 10-32x1/2	1
2J**	R0546600A	Lock Washer, #10	1

(*)May have a letter prefix

** CSA approved models only.

WB Large Base (WB75 and WB150)

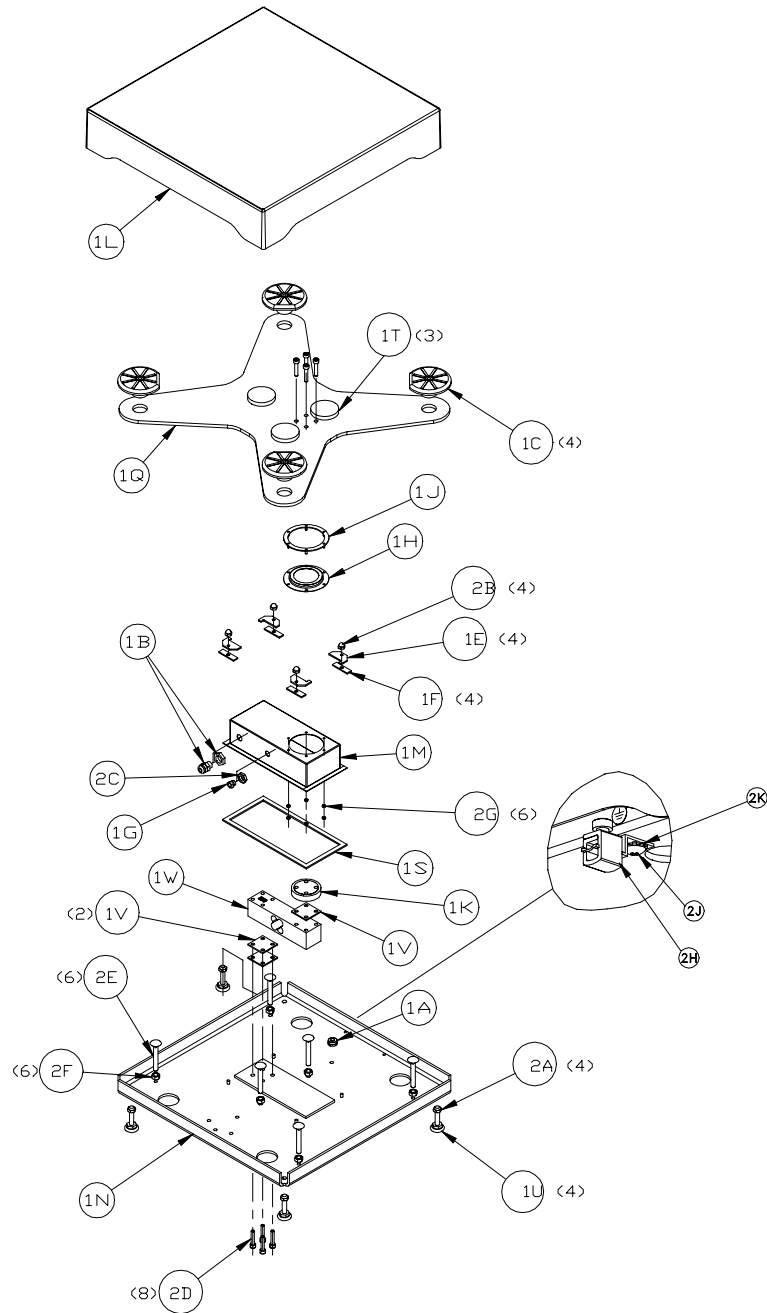

Parts List – WB Large Base Assembly			
Ref. #	Part Number	Description	Qty
1A	(*)10268900A	Level	1
1B	(*)12901800A	Grip Bushing	1
1C	(*)15083900A	Platter Pad, Corner	4
1E	(*)15219600A	Bracket, Hold Down	4
1F	(*)15419800A	Spacer, 1.5 x .43	4
1G	(*)15473000A	Vent, Breather	1
1H	(*)15674700A	Boot, L/C. 18 x 18 SW	1
1J	(*)15674800A	Clamp, Ring 18 x 18 SW	1
1K	(*)15674900A	Adaptor Block Boot 18 x 18 SW	1
1L	(*)15675100A	Platter w/ lip, 18 x 18 (SW)	1
1L	(*)15675000A	Platter, no lip, 18 x 18 (WB)	1
1M	(*)15675200A	Enclosure, L/C, 18 x 18	1
1N	(*)15675300A	Base, 18 x 18	1
1Q	(*)15675400A	Subplatter w/reinforcement	1
1S	(*)15676000A	Gasket, L/C Enclosure, 18 x 18	1
1T	(*)15676100A	Pad, Platter support	3
1U	(*)12900400A	Foot, Adjusting 5/16 – 18	4
1V	(*)14609700A	Spacer, 4 hole load cell	3
1W	(*)15181200A	Load Cell, 100 kg, FM/CSA approved (WB75x)	1
	(*)14654600A	Load Cell, 100 kg (WB75)	1
1W	(*)15181300A	Load Cell, 200 kg, FM/CSA approved (WB150X)	1
	(*)14639000A	Load Cell, 200 kg, (WB150)	1
2A	R0365600A	Nut, Hex, Jam 5/16 – 18	4
2B	R0529100A	Acorn Nut 10 – 32	4
2C	R0542300A	Nut, Hex, 1/8 – Pipe	1
2D	R0511000A	Screw, M6 x 35	8
2E	R0548100A	Bolt, Carriage, 5/16 – 18	6
2F	R0233700A	Nut, Hex, 5/16 – 18	6
2G	R0549500A	Nut, Hex, M3 w/insert	6
2H***	09870100A	Ground Lug	1
2J***	R0357700A	Screw, 10-32 x 1/2	1

Parts List – WB Large Base Assembly			
Ref. #	Part Number	Description	Qty
2K***	R0546600A	Lock Washer #10	1

(*)May have a letter prefix

** Not included with this model.

***CSA Approved Models only

METTLER TOLEDO

Publication Feedback Form

If you find a problem with our documentation, please complete and fax this form to (614) 438-4355

Publication Name: METTLER TOLEDO WB Washdown Base Technical Manual and User's Guide

Publication Part Number: A15623600A Publication Date: 10/99.01

PROBLEM(S) TYPE:	DESCRIBE PROBLEM(S):	INTERNAL USE ONLY
<input type="checkbox"/> Technical Accuracy	<input type="checkbox"/> Text <input type="checkbox"/> Illustration	
<input type="checkbox"/> Completeness What information is missing?	<input type="checkbox"/> Procedure/step <input type="checkbox"/> Illustration <input type="checkbox"/> Definition <input type="checkbox"/> Example <input type="checkbox"/> Guideline <input type="checkbox"/> Feature <input type="checkbox"/> Explanation <input type="checkbox"/> Other (please explain below)	<input type="checkbox"/> Info. in manual <input type="checkbox"/> Info. not in manual
<input type="checkbox"/> Clarity What is not clear?		
<input type="checkbox"/> Sequence What is not in the right order?		
<input type="checkbox"/> Other Comments Use another sheet for additional comments.		

Your Name: _____ Location: _____

Phone Number: (____) _____

Fax to Industrial Marketing (614) 438-4355

METTLER TOLEDO
Scales & Systems

1900 Polaris Parkway
Columbus, Ohio 43240
USA

Phone: 800-786-0038
(614) 438-4511

FAX: 614-438-4900

Internet: www.mt.com

A15623600A
(10/99).01

METTLER TOLEDO, SPIDER[®], JAGUAR[®], LYNX[®], PUMA[®], PANTHER[®], and LYNXBATCH[®] are registered trademarks of Mettler-Toledo, Inc.
©1998 Mettler-Toledo, Inc.

Printed in U.S.A.

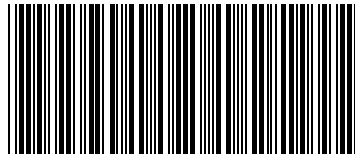

A15623600A