

ROUND BEAM LOAD CELL

Replaces:

- Toledo 11785600A-500 lb
- Toledo 11786900A-1k
- Toledo 11744500A-1k
- Toledo 11788500A-2k
- Toledo Low Profile Platform 2155

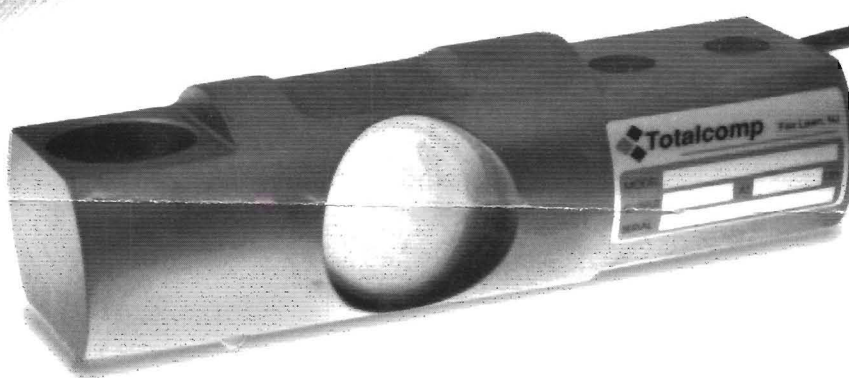

Model TB3

**Improved single ended round beam load cell
makes a great replacement for
Toledo low profile platform bases.**

- ✓ **500 lbs., 1K, & 2K lbs. capacities.**
- ✓ **Low profile.**
- ✓ **Meets NIST H-44 requirements.**
- ✓ **Environmentally sealed.**
- ✓ **Stainless Steel.**
- ✓ **Heavy duty construction.**
- ✓ **Optional Bearing cup and ball.**



Totalcomp® Scales & Components

13-01 Pollitt Drive • Fair Lawn, New Jersey 07410

Fax: 201-797-2287 • Toll Free Fax: 888-797-2288 • Phone: 201-797-2718 • Toll Free Phone: 800-631-0347

SPECIFICATIONS

Model TB3 ROUND BEAM LOAD CELL

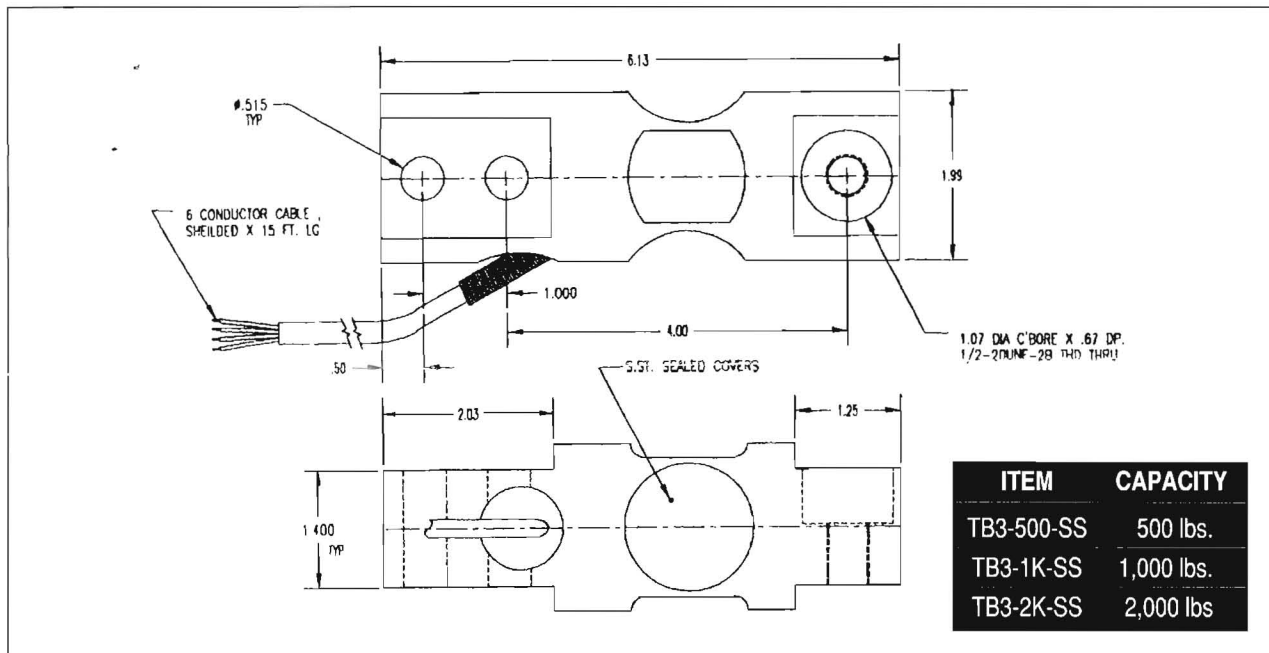

This load cell features exclusive heavy duty, stainless steel construction. Made to withstand harsh environments, the TB3 is thoroughly potted and has a special protective stainless steel shield over the strain gage area. This superior new design eliminates the use of neoprene boots.

Interchangeable with Toledo beam load cells for 2095 / 2155/2885 platforms.

Rated Output

2 mv/v $\pm 0.1\%$

Nonlinearity

$\pm 0.02\%$

Operating Temperature Range

0°F to +115°F

Compensated Temperature Range

0-150°F

Recommended Excitation

0-15 volts DC

Temp. Effect on Span

.0007% RO

Temp. Effect on Zero

.0013% RO

Creep

.02% RO in 20 minutes

Input Resistance

440 Ohms nominal

Output Resistance

450 Ohms nominal

Safe Overload

150% of rated capacity

Cable Color Code

Green.....+ Output
Black.....- Output
White.....+ Input
Blue.....- Input
Yel.....+ Sens
Red.....- Sens
Bare.....Shield

TOTALCOMP LIMITED WARRANTY

Totalcomp warrants this products to be free of defects in materials and/or workmanship and suitable for the purpose(s) intended as outlined on this sheet. This warranty is effective and shall cover the purchaser for one year from the date of shipment from our plant. If this product is found to be defective by our inspection in accordance with the above listed criteria, we will replace or repair it at our expense. For warranty service, please obtain a return authorization number from us and return the item, shipping prepaid, with a written description of the problem. We will respond promptly with the results of our evaluation.



Totalcomp®

Scales & Components

13-01 Pollitt Drive

Fair Lawn, NJ 07410

Fax (201) 797-2287

Toll Free Fax (888) 797-2288

Phone (201) 797-2718

Toll Free Phone (800) 631-0347

TB3-9/97-2.5M