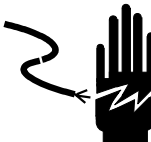

Description: Tower Installation
For Model: 8450 Self Service Pictogram

Unpack the Model 8450 base, platter, tower, and mounting hardware.

Follow Step 1 through Step 6, as shown in Figure 1 and Figure 2.

	<p>WARNING</p> <p>DISCONNECT ALL POWER TO THIS UNIT BEFORE INSTALLING, SERVICING, CLEANING, OR REMOVING THE FUSE. FAILURE TO DO SO COULD RESULT IN BODILY HARM AND/OR PROPERTY DAMAGE.</p>
--	---

	<p>CAUTION</p> <p>OBSERVE PRECAUTIONS FOR HANDLING ELECTROSTATIC SENSITIVE DEVICES.</p>
--	--

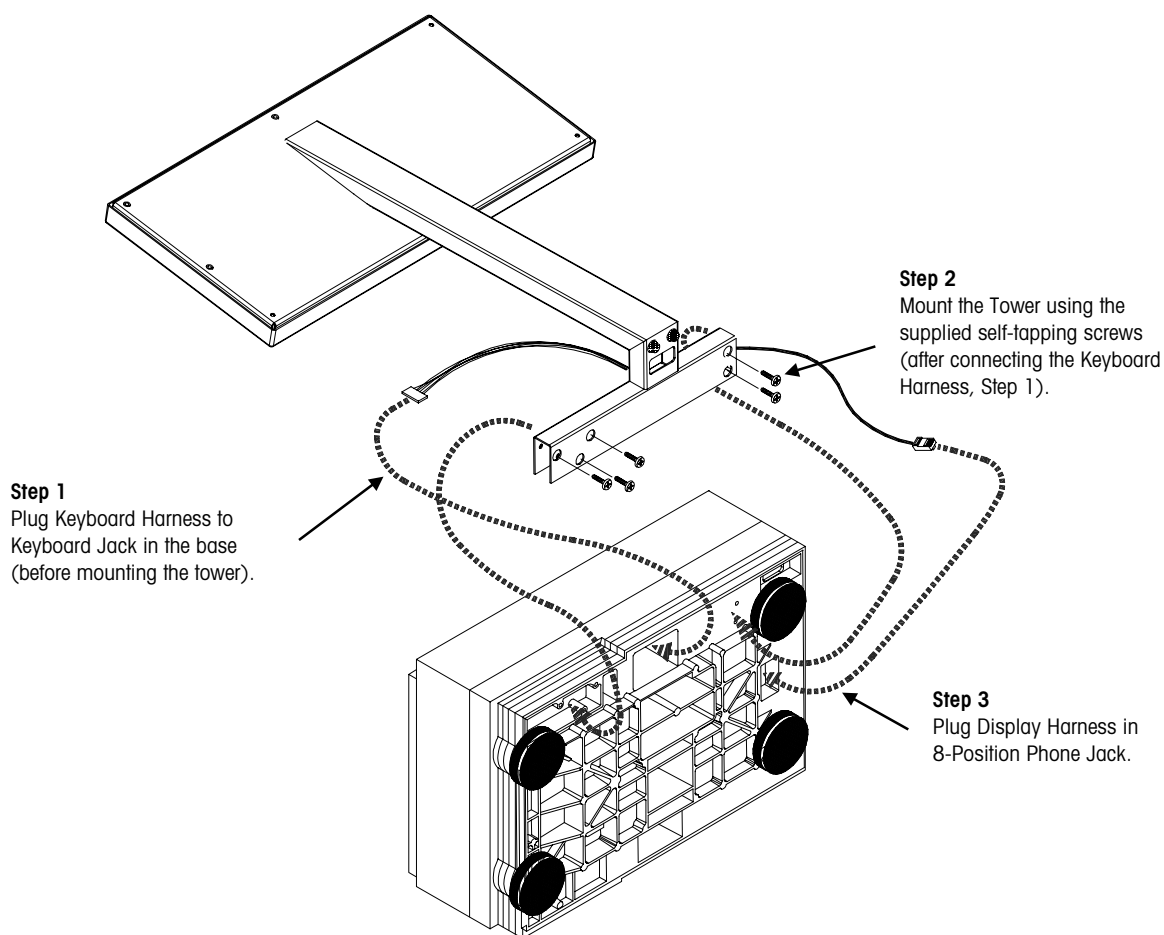

Figure 1: Tower Installation

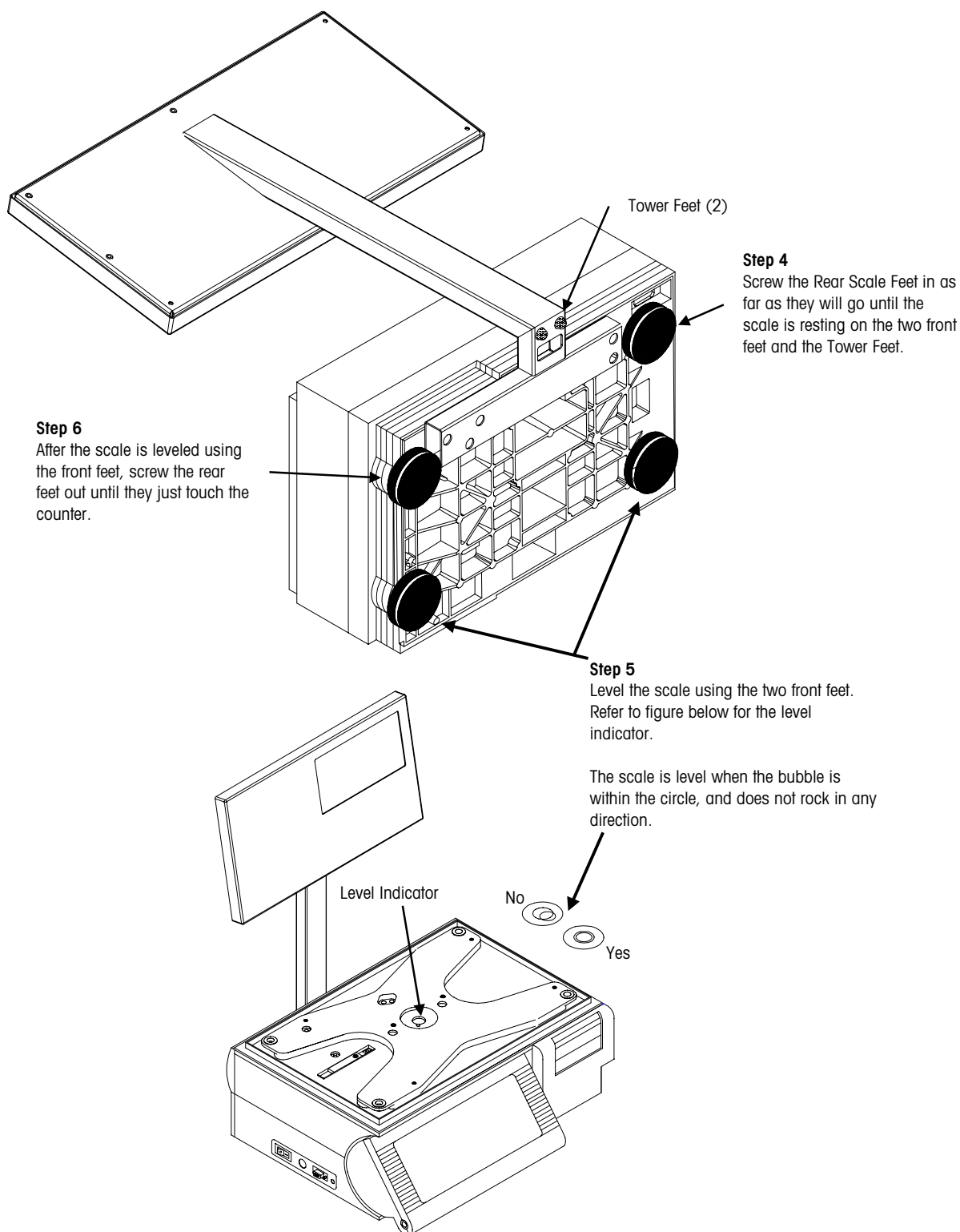

Figure 2: Leveling the Scale