

Model: 8450/355

Kit Number: 0977-0054

Description: Main PCB Upgrade Kit

Kit Description

This kit will upgrade the Model 8450 and 355 to the newer Ethernet capable Main PCB (*)15138700A. This kit is required before installing the Ethernet Upgrade Kit if the Model 8450/355 Main PCB is the older (*)14475900A PCB.

Kit Installation in the Model 8450

Disconnect the AC power cord from the outlet before proceeding.

Remove the printer cover. Remove the platter and spider (on units with load cell) or the dead deck cover (on dead deck units). Next remove the top cover screws. Slightly lift the top cover and disconnect the keyboard harnesses, then remove the top cover assembly.

Disconnect the load cell, power supply, and printer harnesses from the Main PCB. Remove the three mounting screws (Figure 2). Lift the Main PCB up on the side opposite the power supply enough to clear the power supply, then remove the Main PCB. Install the new Main PCB in reverse order.

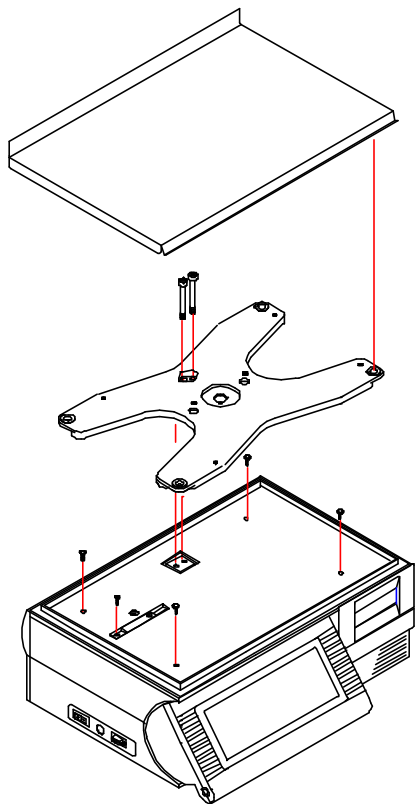
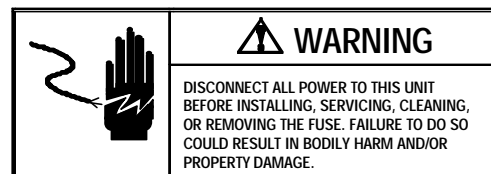

Figure 1: Removing Covers

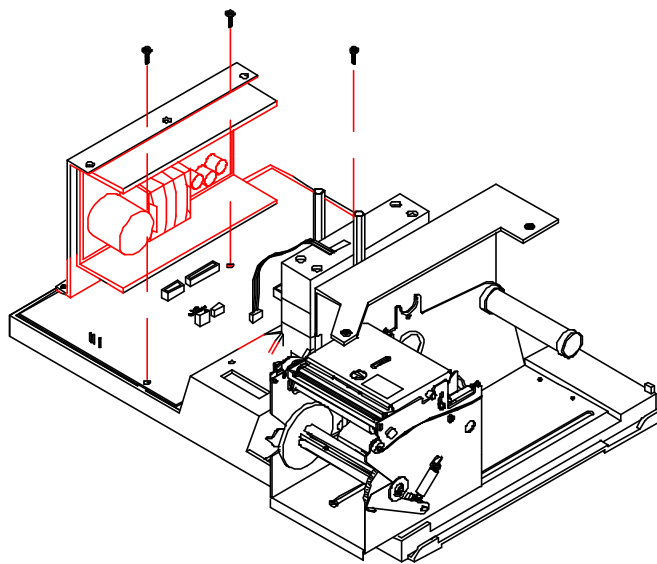

Figure 2: Removing Main PCB Model 8450

Kit Installation in the Model 355

Disconnect the AC power cord from the outlet before proceeding.

Remove the left printer cover. Disconnect the power supply and printer harnesses from the Main PCB. Remove the three mounting screws (Figure 3). Remove the Main PCB. Install the new Main PCB in reverse order.

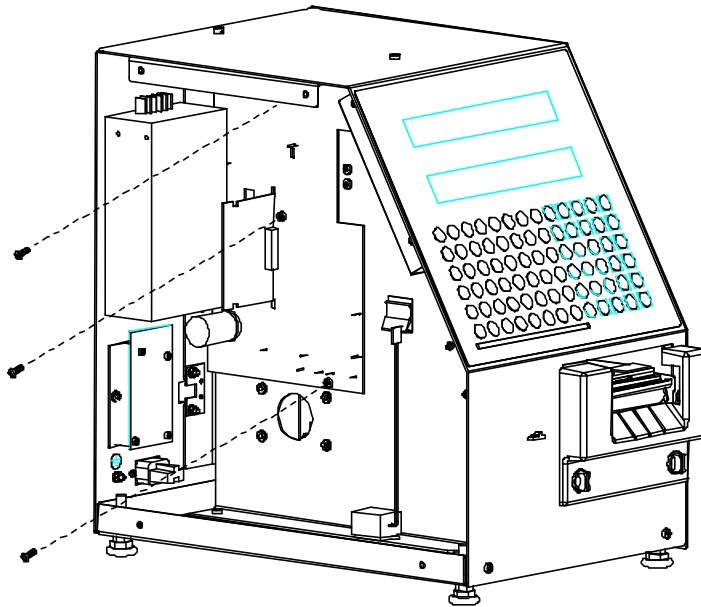

Figure 3: Removing Main PCB Model 355

	<p>WARNING</p> <p>DISCONNECT ALL POWER TO THIS UNIT BEFORE INSTALLING, SERVICING, CLEANING, OR REMOVING THE FUSE. FAILURE TO DO SO COULD RESULT IN BODILY HARM AND/OR PROPERTY DAMAGE.</p>
	<p>CAUTION</p> <p>OBSERVE PRECAUTIONS FOR HANDLING ELECTROSTATIC SENSITIVE DEVICES.</p>