

661-1012

Hand Wrap Station

Service Manual

©Mettler-Toledo, Inc. 2000

No part of this manual may be reproduced or transmitted in any form or by any means, electronic or mechanical, including photocopying and recording, for any purpose without the express written permission of Mettler-Toledo, Inc.

U.S. Government Restricted Rights: This documentation is furnished with Restricted Rights.

METTLER TOLEDO®

Customer Feedback

Attention: Retail Quality Manager - MTWR

If you have a problem with one of our products or publications, or just a suggestion on how we can serve you better, please fill out this form and send it to the address on the opposite side of this page (U.S. postage paid), or fax it to us at **(614) 438-4355**. Your feedback will help us to improve product performance, quality, and service.



METTLER TOLEDO

Part / Product Name:	
Part / Model Number:	Date:
Provided By:	
Customer Name:	
Address:	
Phone Number:	Fax Number:

Your comments on product performance, quality, or service:

Do not write in space below. For METTLER TOLEDO use only.

Response (where appropriate). Include root cause analysis and corrective action taken.

METTLER TOLEDO
Scales & Systems
1900 Polaris Parkway
Columbus, Ohio 43240

METTLER TOLEDO® is a registered trademark of Mettler-Toledo, Inc.

©2000 Mettler-Toledo, Inc.

Printed in USA

FOLD THIS FLAP FIRST

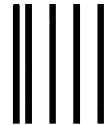

NO POSTAGE
NECESSARY IF
MAILED IN THE
UNITED STATES

BUSINESS REPLY MAIL

FIRST CLASS PERMIT NO. 414 COLUMBUS, OH

POSTAGE WILL BE PAID BY ADDRESSEE

Mettler-Toledo, Inc.
Worthington Manufacturing Facility MTWR
P.O. Box 1705
Columbus, OH 43216
USA

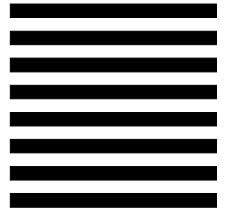

Please seal with tape.

INTRODUCTION

This publication is provided solely as a guide for individuals who have received Technical Training in servicing the METTLER TOLEDO product.

Information regarding METTLER TOLEDO Technical Training may be obtained by writing to:

METTLER TOLEDO
1900 Polaris Parkway
Columbus, Ohio USA 43240
(614) 438-4511

FCC Notice

This device complies with Part 15 of the FCC Rules and the Radio Interference Requirements of the Canadian Department of Communications. Operation is subject to the following conditions: (1) this device may not cause harmful interference, and (2) this device must accept any interference received, including interference that may cause undesired operation.

This equipment has been tested and found to comply with the limits for a Class A digital device, pursuant to Part 15 of FCC Rules. These limits are designed to provide reasonable protection against harmful interference when the equipment is operated in a commercial environment. This equipment generates, uses, and can radiate radio frequency energy and, if not installed and used in accordance with the instruction manual, may cause harmful interference to radio communications. Operation of this equipment in a residential area is likely to cause harmful interference in which case the user will be required to correct the interference at his own expense.

**METTLER TOLEDO RESERVES THE RIGHT TO MAKE REFINEMENTS OR
CHANGES WITHOUT NOTICE.**

PRECAUTIONS

Read the following instructions carefully before installing, operating, cleaning, or maintaining your new Hand Wrap Station. Save these instructions for future reference.

Contact your supplier of heat sealable wrapping films to verify that the films you are using with heated belt sealers do not release toxic fumes at temperatures below 700°F.

Operate wrapping and sealing equipment only in a well ventilated area.



Do not allow untrained personnel to install, operate, clean, inspect, or maintain this machine.

Be sure the Hand Wrap Station is connected to a properly grounded outlet of the correct voltage and amperage, as specified on the identification plate. Do not remove ground prong from PLUG.

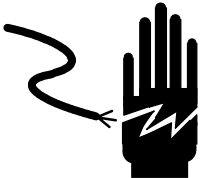

ALWAYS disconnect the Hand Wrap Station from the power source before threading film, cleaning, maintaining, or inspecting.

Keep hands and loose clothing away from hot surfaces such as Low Temperature Cutoff Rod and Sealing Plate while operating, cleaning, maintaining, or inspecting.

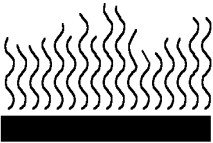

CALL METTLER TOLEDO for parts, information, and service.

	<div>WARNING</div> <div>DISCONNECT ALL POWER TO THIS UNIT BEFORE INSTALLING, SERVICING, CLEANING, OR REMOVING THE FUSE. FAILURE TO DO SO COULD RESULT IN BODILY HARM AND/OR PROPERTY DAMAGE.</div>
---	--

	<div>CAUTION</div> <div>SURFACES MAY BE HOT EVEN THOUGH POWER SWITCH IS IN THE "OFF" POSITION.</div>
---	--

	<div>CAUTION</div> <div>OPERATE THIS EQUIPMENT ONLY IN A WELL VENTILATED AREA. VERIFY THE FILM IS INTENDED FOR LOW TEMP ROD CUTOFF AND HOT SEALING PLATES AND DOES NOT RELEASE TOXIC FUMES.</div>
---	---

<div>CAUTION</div> <div>50 LB MAXIMUM LOAD LOADS IN EXCESS OF 50 LB COULD RESULT IN IMPROPER MACHINE OPERATION OR DAMAGE</div>	
---	--

<div>CAUTION</div>		<div>— HOT — DO NOT TOUCH HEATING ELEMENTS P/N 12021200A</div>
--	---	---

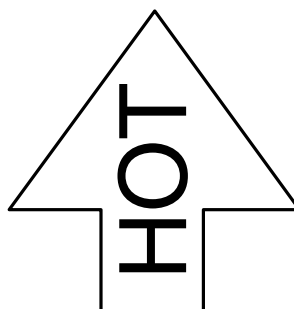

P/N 81876200A

CONTENTS

1	General Description	1-1
2	Specifications	2-1
	Agency Approval	2-1
	Environmental Requirements.....	2-1
	Power Requirements	2-1
	Film Capacity	2-1
3	Safety and Precautions	3-1
4	Setup	4-1
	Setup.....	4-1
	Film Threading	4-1
	Adjusting Film Tension.....	4-2
5	Operator Controls.....	5-1
	Power Switch	5-1
	Low Temp Cutoff Rod	5-1
6	Cleaning and Maintenance	6-1
	General Precautions	6-1
	Low Temp Cutoff Rod	6-1
	Frame and Shelves	6-2
	Film Support Rollers.....	6-2
	Troubleshooting	6-2
7	Replacement Parts	7-1
	Frame.....	7-2
	Frame Parts List	7-3
	Roller and Film Brake Assembly	7-4
	Roller and Film Brake Parts List.....	7-5
	Low Temp Cutoff Rod and Control Panel	7-6
	Part List for Low Temp Cutoff Rod and Control Panel	7-7
8	Accessories	8-1
	Accessory Illustration	8-2
	Parts List for Accessories	8-3
9	Wiring Diagram	9-1

1

General Description

The Mettler Toledo Model 661-1012 Prewrap Hand Wrap Station (Figure 1-1) is designed to increase wrapping production. The Model 661-1012 is designed to be used with a belt sealer and does not have a sealing plate.

Features include a low temp film cutoff rod, flip away film selectors and three sets of arborless film supports.

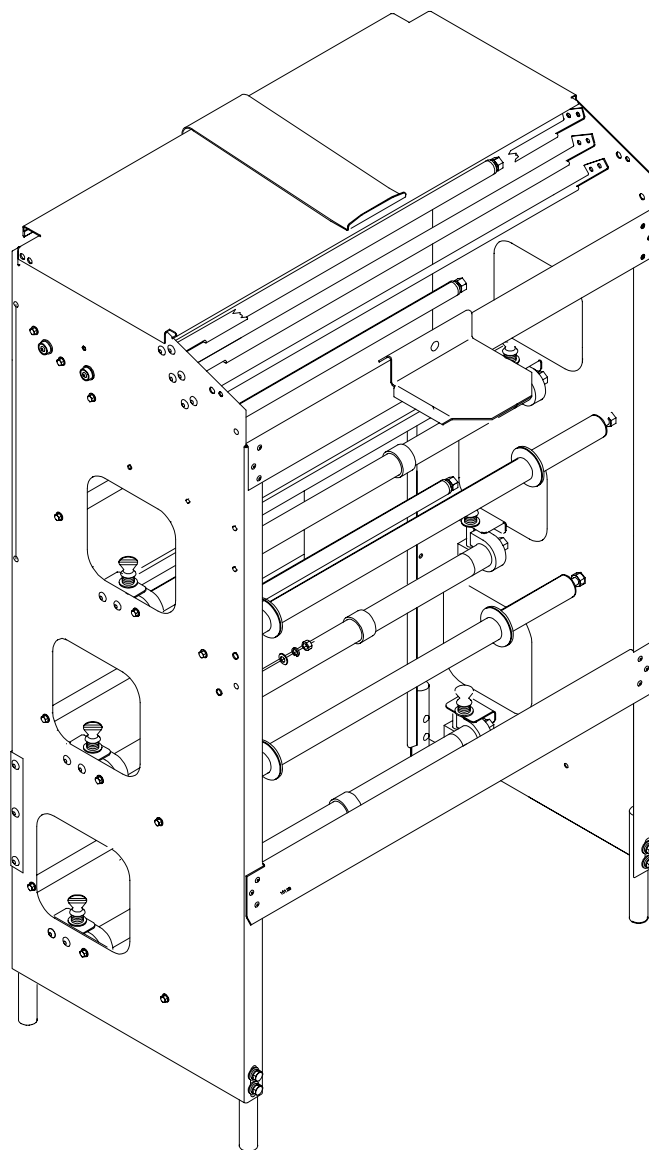
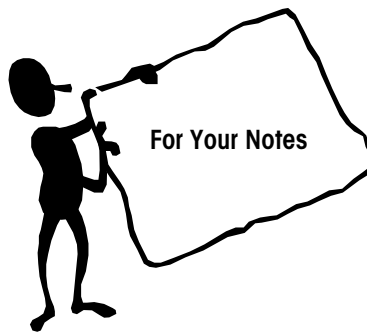

Figure 1-1: Model 661-1012



2

Specifications

Agency Approval

UL and CSA approved.

Environmental Requirements

The Model 661 Hand Wrap operating range is between +5° to +35°C (+41° to +95°F) at 10% to 95% relative humidity, non-condensing. The shipping and storage temperature range is between 0°C to +66°C (+32°F to +150°F) at 10% to 95% relative humidity, non-condensing. The Model 661 is designed for use in prepackaging backroom environments. The Model 661 is not intended for wash-down operation, nor for operation in environments of extreme dust, heat, cold, or humidity. No NEMA rating applies.

Power Requirements

The Model 661 requires 115 VAC, 60 Hz., single phase, power at 6 amps nominal to operate. The circuit must be properly grounded.

Film Capacity

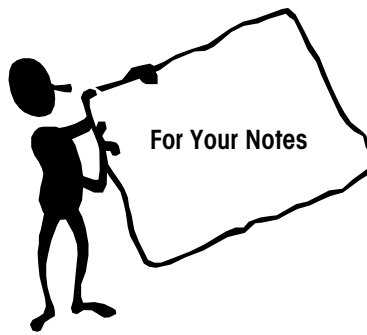

The Model 661 will accept 3 rolls of film up to 20" wide.



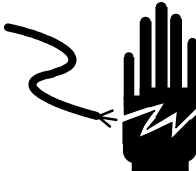

3

Safety and Precautions

Before cleaning or servicing this unit, disconnect AC power by turning the power switch off, then unplugging the AC line cord from the outlet. Failure to observe these precautions could result in bodily harm.

	<div> WARNING</div> <div>DISCONNECT ALL POWER TO THIS UNIT BEFORE INSTALLING, SERVICING, CLEANING, OR REMOVING THE FUSE. FAILURE TO DO SO COULD RESULT IN BODILY HARM AND/OR PROPERTY DAMAGE.</div>
---	---

Do not allow untrained personnel to operate, clean, inspect, maintain, service, or tamper with this equipment.



	<div> WARNING</div> <div>ONLY PERMIT QUALIFIED PERSONNEL TO SERVICE THIS EQUIPMENT. EXERCISE CARE WHEN MAKING CHECKS, TESTS AND ADJUSTMENTS THAT MUST BE MADE WITH POWER ON. FAILING TO OBSERVE THESE PRECAUTIONS CAN RESULT IN BODILY HARM.</div>
--	--

Caution, Low Temp Cutoff Rod and Sealing Plate may be hot even though power switch is in the off position.

	<div> WARNING</div> <div>Surfaces may be hot. Allow to cool before cleaning or servicing.</div>
---	---

Always replace labels which are damaged, illegible or missing.

Contact your film supplier to verify that the film you are using is intended for use with a low temp rod cutoff and hot sealing plates and does not release toxic fumes. Operate this equipment only in a well ventilated area.

	 CAUTION
	OPERATE THIS EQUIPMENT ONLY IN A WELL VENTILATED AREA. VERIFY THE FILM IS INTENDED FOR LOW TEMP ROD CUTOFF AND HOT SEALING PLATES AND DOES NOT RELEASE TOXIC FUMES.

4

Setup

Setup

See the Accessories pages in the of this manual for attachment information.

Film Threading

Load three rolls of film onto the arborless film cradles. Any size film width from 12" to 20" may be used. It is recommended that the large roll of film be placed on the bottom cradle, the medium roll on the middle cradle, and the small roll on the top cradle.

Before placing the roll of film on its cradle, orient the Film Roll so that the end of the film will hang down between the cradle rollers, and the film will dispense from the top of the roll towards the back of the Model 661. (Refer to the Film Threading Diagram, Figure 4-1)

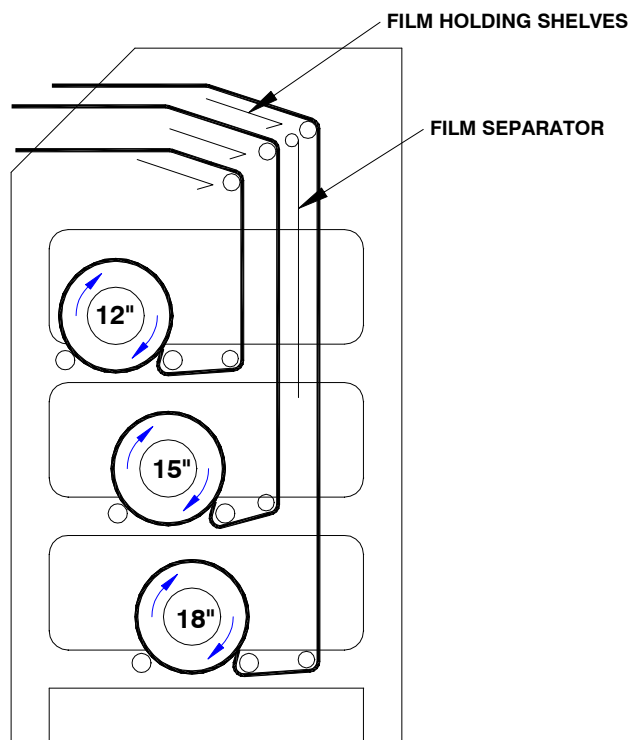

Figure 4-1: Film Threading Diagram - 3 Rolls of Film

Center the film rolls on their respective rollers. Position the Film Roll Retaining Grommets approximately 1/4" away from the ends of the film roll. (Refer to Figure 4-2)

Thread the film through the film rollers and into the Film Selector as shown in the Film Threading Diagram. (Figure 4-1)

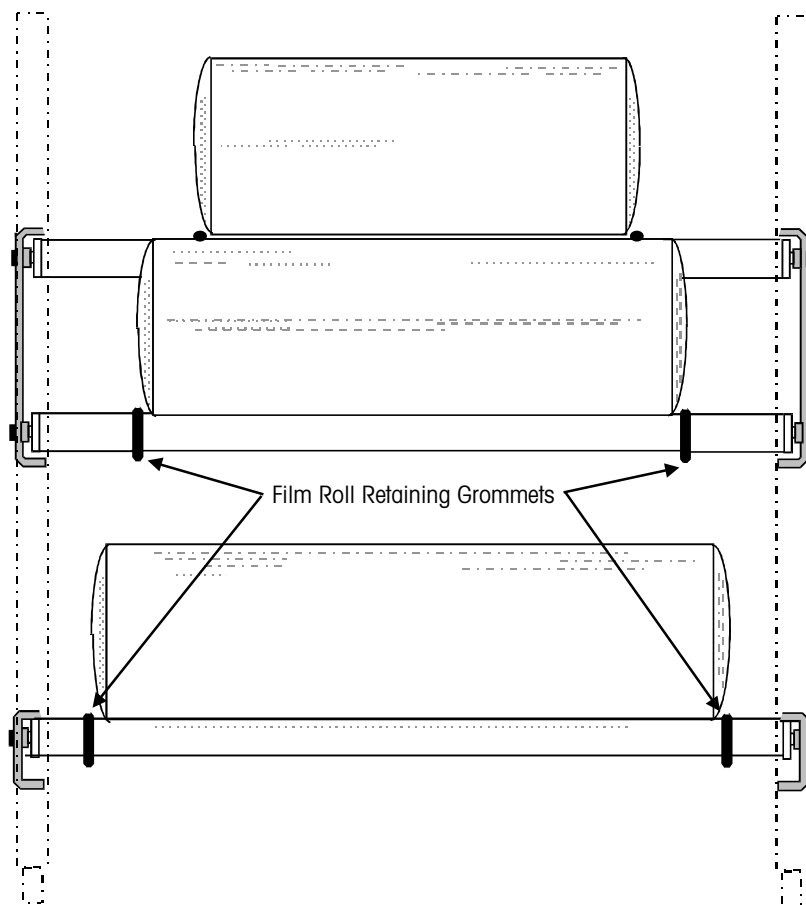

Figure 4-2: Film Roll Retaining Grommet

Tear or cut the end of the film straight across, and fold the end of the film neatly over the Film Leaf. (Figure 4-3).

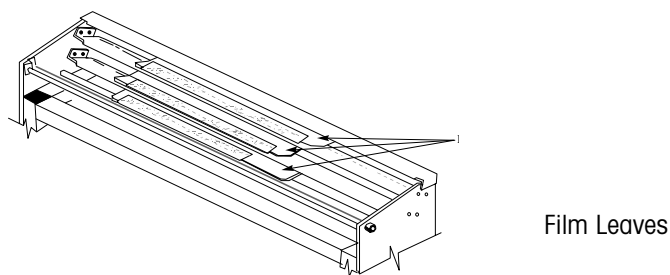

Figure 4-3: Film Leaf

Adjusting Film Tension

The film tension should be adjusted to suit your wrapping comfort. It should be loose enough so that the film pulls easily from the roll, yet tight enough to stretch the film as you pull it, to allow you to produce a tight, wrinkle-free package. To provide better control of film tension, this machine is equipped with a dual braking system for each

Chapter 4: Setup

Adjusting Film Tension

film roll. A Film Brake is located at each end of the front Film Support Roller of each roll of film (Figure 4-4). The film tension is adjusted by loosening or tightening the Film Roller Brakes. To increase the film tension, turn the Film Roller Brake Adjusting Screw clockwise. To decrease the film tension, turn the Film Roller Brake Adjusting Screw counterclockwise.

For uniform pull on the film, both brakes on a Film Support Roller must be set for equal tension. Before installing a roll of film, loosen each brake so the roller turns freely. Then tighten each adjusting screw until the brake is lightly snugged against the roller. After the roll is mounted, adjust the tension, as desired, by turning both adjusting screws in 1/4 turn increments.

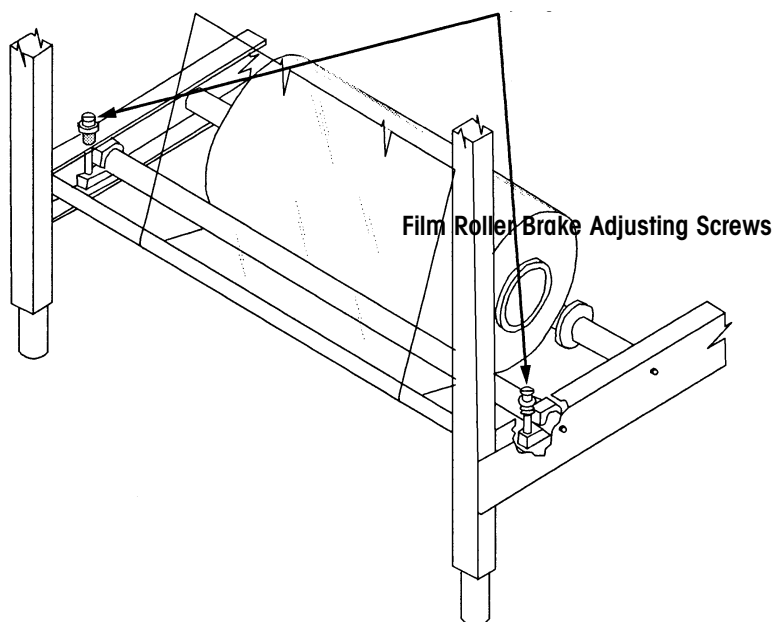
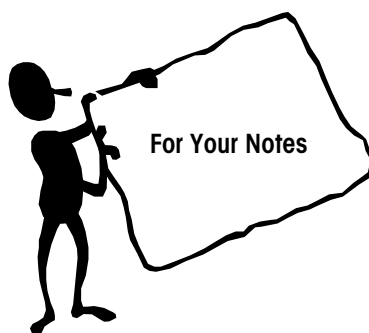

Figure 4-4: Film Roller Brake Adjusting Screws



5

Operator Controls

Power Switch

The Power Switch is located on the right side of the Model 661-1012 under the top shelf. The switch controls power to the Low Temperature Cutoff Rod.

Low Temp Cutoff Rod

The temperature of the Cutoff Rod is thermostatically controlled. The temperature is set at the factory and is not adjustable. Allow 15 minutes when first turning the power on for the Low Temp Cutoff Rod to reach operating temperature.

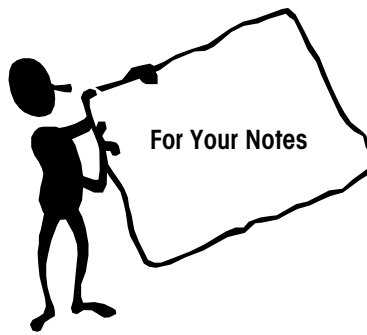

6

Cleaning and Maintenance

General Precautions

	<p> WARNING</p> <p>DISCONNECT ALL POWER TO THIS UNIT BEFORE INSTALLING, SERVICING, CLEANING, OR REMOVING THE FUSE. FAILURE TO DO SO COULD RESULT IN BODILY HARM AND/OR PROPERTY DAMAGE.</p>
	<p> WARNING</p> <p>DO NOT SPRAY OR WASHDOWN. HAZARD OF ELECTRICAL SHOCK OR BURNS.</p>
<p> WARNING</p> <p>DO NOT USE SOLVENTS, CHEMICALS, OR ABRASIVES ON MACHINE, AS THESE MAY HARM SURFACES.</p>	

Low Temp Cutoff Rod

	<p> CAUTION</p> <p>SURFACES MAY BE HOT EVEN THOUGH POWER SWITCH IS IN THE "OFF" POSITION.</p>
---	--

- Turn power off, then disconnect the power cord from the outlet.
- Allow to cool down before cleaning.
- Clean daily, using a dampened scouring pad. Do not use abrasives, such as emery cloth or sand paper.

Frame and Shelves

Clean daily, using a clean, damp cloth and a mild detergent.

Film Support Rollers

When replacing a roll of film, the Film Support Rollers and the Film Guide Rollers should be cleaned to remove any particles or burrs that could puncture the film. Clean the rollers with a clean, damp cloth and mild detergent.

Troubleshooting

- Is the machine connected to a properly grounded outlet of the correct amperage and voltage?
- Are the circuit breakers in the building service panel in the ON position?
- Is the power switch in the ON position?
- Is the Low Temp Cutoff Rod clean?
- Is the film loaded and threaded properly?
- Are the Film roller brakes adjusted properly?
- Are the film support rollers clean and free of burrs?

7

Replacement Parts

Chapter 7 covers replacement part numbers. Carefully check your part numbers for accuracy before ordering.

Frame

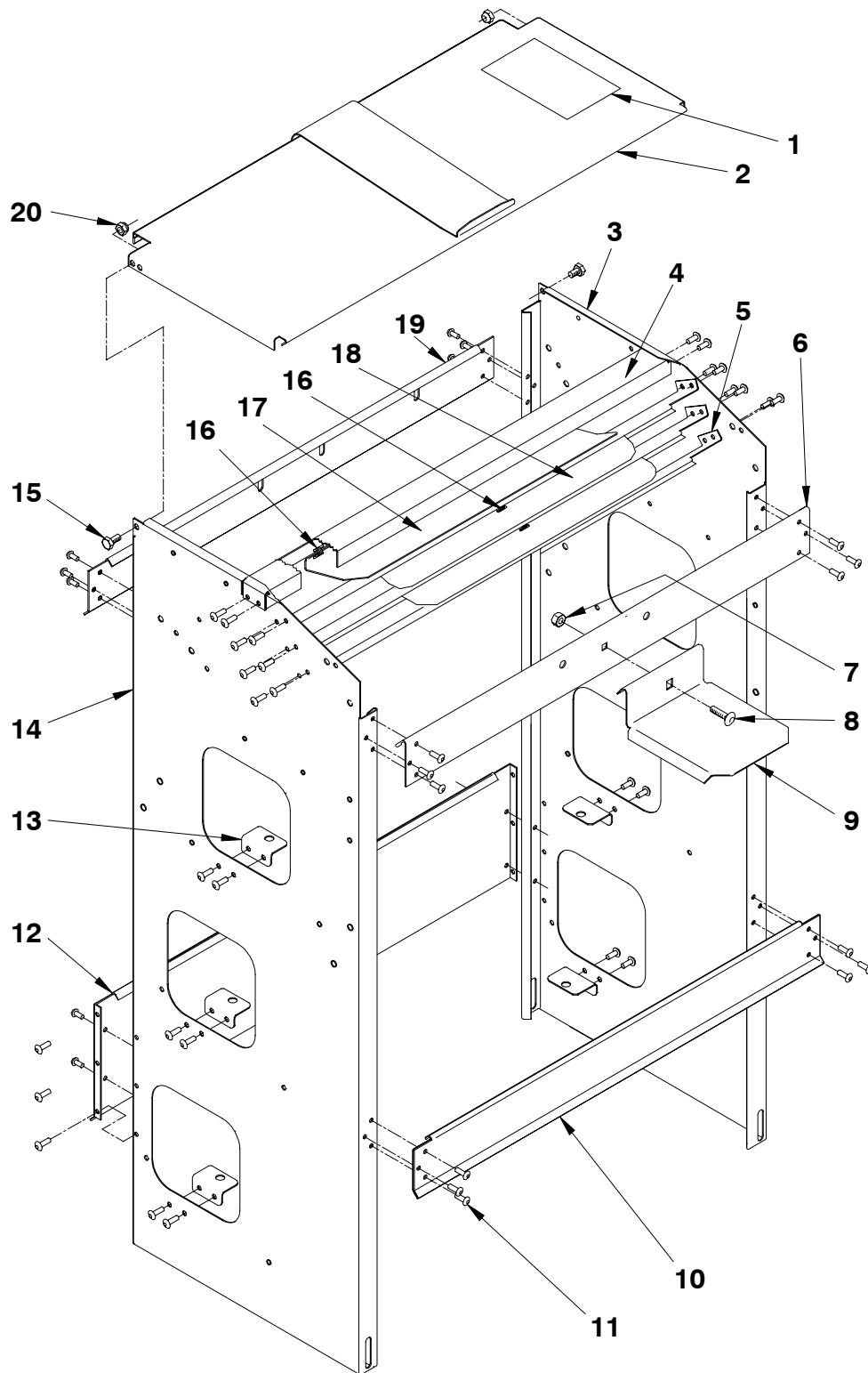

Frame Parts List

ITEM	QTY.	DESCRIPTION	PART NUMBER
1	1	DECAL - FILM THREADING	81875400A
2	1	TABLE COVER WELDMENT	82200500A
3	1	FRAME RH	A82200300A
4	1	TOP BRACE	82200600A
5	3	SHELF - FILM	81878100A
6	1	TIE BAR FRONT TOP	81873900A
7	1	NUT 1/4-20 HEX JAM	R0236900A
8	1	CARRIAGE SCREW 1/4-20 X 1/2	RO364000A
9	1	PACKAGE REST	81874000A
10	1	BAR LOWER FRONT TIE	81868700A
11	44	POP RIVOT	81868000A
12	1	BAR LOWER REAR TIE	81882700A
13	1	CLIP - BRAKE	82484500A
14	1	FRAME LH	A2220400A
15	2	SCREW 1/4-20 X 5/8 LONG HEX HEAD CAP	R0234600A
16	4	SPRING - FILM STOP MOUNTING	A81124500A
17	1	LEAF TOP FILM	82266300A
18	2	STOP - MIDDLE FILM	81880600A
19	1	TIE BAR - UPPER REAR	81873000A
20	2	LOCK NUT 1/4-20 HEX	A80302800A

Roller and Film Brake Assembly

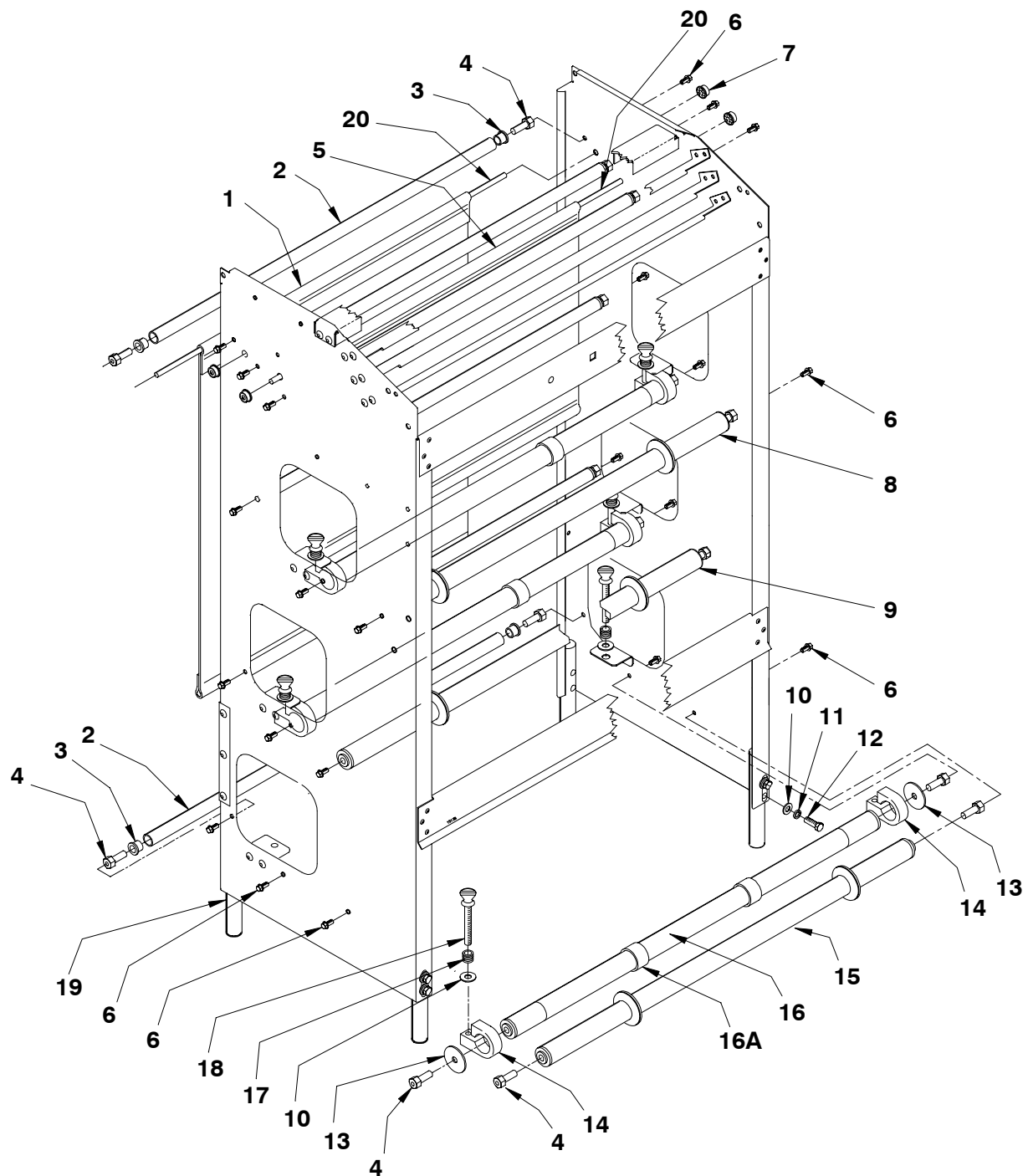

Roller and Film Brake Parts List

ITEM	QTY.	DESCRIPTION	PART NUMBER
1	1	ROD & CANVAS ASSEMBLY	82150200A
2	6	ROLLER 5/8 DIA. X 22-9/32 LONG	82138700A
3	12	BEARING FLANGE	A80190400A
4	24	MOUNTING STUD	82130000A
5	1	ROD & CANVAS ASSEMBLY	82223800A
6	24	SCREW 10-32 X 3/8 HEX WASHER HD.	A81160600A
7	4	PUSH NUT	A80357800A
8	1	ROLLER & GROMMET ASSEM. - 18" FILM	81924000A
9	1	ROLLER & GROMMET ASSEM. - 15" FILM	81923900A
10	14	WASHER 5/16 FLAT	R0234300A
11	8	WASHER 5/16 LOCK	R0233500A
12	8	SCREW 5/16-18 X 3/4 HEX HD. CAP	R0364100A
13	6	WASHER - BRAKE RETAINING	82138100A
14	6	BRAKE - RETAINING	81832200A
15	1	ROLLER & GROMMET ASSEM. - 12" FILM	81923800A
16	3	ROLLER ASSEM. FILM SUPPORT W/SLEEVE	82451400A
16A	6	SILICON SLEEVE	82941000A
17	6	SPRING - BRAKE	81868100A
18	6	THUMB SCREW - BRAKE	81868200A
19	4	LEG - WRAP STATION	A81870200A
20	3	ROD - COVER AND FILM	81870500A

Low Temp Cutoff Rod and Control Panel

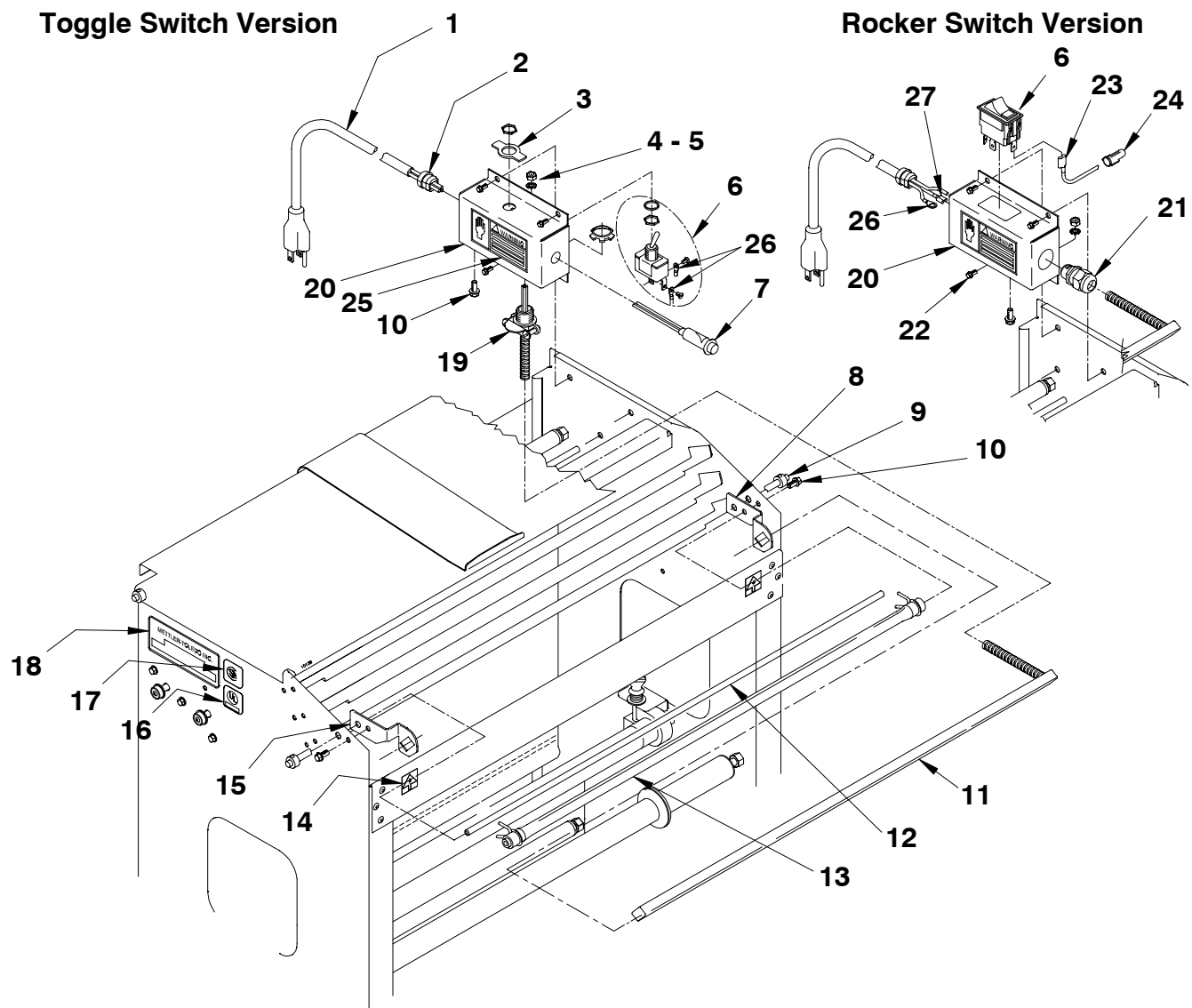

Part List for Low Temp Cutoff Rod and Control Panel

ITEM	QTY.	DESCRIPTION	PART NUMBER
1	1	CORD SET #16-3	A80958700A
2	1	CORD GRIP STRAIGHT	A80942900A
3	1	PLATE ON/OFF SWITCH	A80281100A
4	1	NUT #10-32 HEX	R0342000A
5	1	LOCK WASHER #10 EXTERNAL TOOTH	R0254500A
6	1	SWITCH MAIN POWER (TOGGLE)	A80658800A
	1	SWITCH MAIN POWER (ROCKER)	A82351600A
7	1	PILOT LIGHT - RED	81845200A
8	1	SUPPORT - LOW TEMP ROD - RH	81835900A
9	2	SET COLLAR - 1/4" I.D.	81895700A
10	3	SCREW 10-32 X 3/8" HEX WASHER HEAD	A81160600A
11	1	SQUARE HEATER 1/2 X 22.75 LONG	A82086700A
12	1	ROD - COVER & FILM	81870500A
13	1	FILM RETAINING TUBE AND SHAFT	A80319300A
14	2	DECAL - HOT ARROW	81876200A
15	1	SUPPORT - LOW TEMP LH	81835800A
16	1	LABEL - UL LISTED	82462000A
17	1	CSA LABEL	82519100A
18	1	LABEL - SERIAL	82531000A
19	1	CONNECTOR - 3/8 STRAIGHT	A80078300A
20	1	CONTROL BOX (FOR TOGGLE SWITCH)	81869300A
	1	CONTROL BOX (FOR ROCKER SWITCH)	82948100A
21	1	HEYCO CONNECTOR - STRAIGHT	82474700A
22	1	SCREW #8-32 X 1/4 HEX WASHER HD.	R0235200A
23	1	JUMPER WIRE	82949200A
24	1	WIRE NUT	A80281000A
25	1	WARNING DECAL	81921300A
26	2	RING TERMINAL	81283800A
27	1	SLIP ON TERMINAL	10502800A

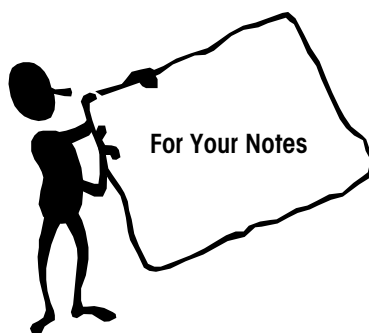

8

Accessories

Chapter 8 covers optional accessories for the Model 661-1012. Carefully check your part numbers for accuracy before ordering.

Accessory Illustration

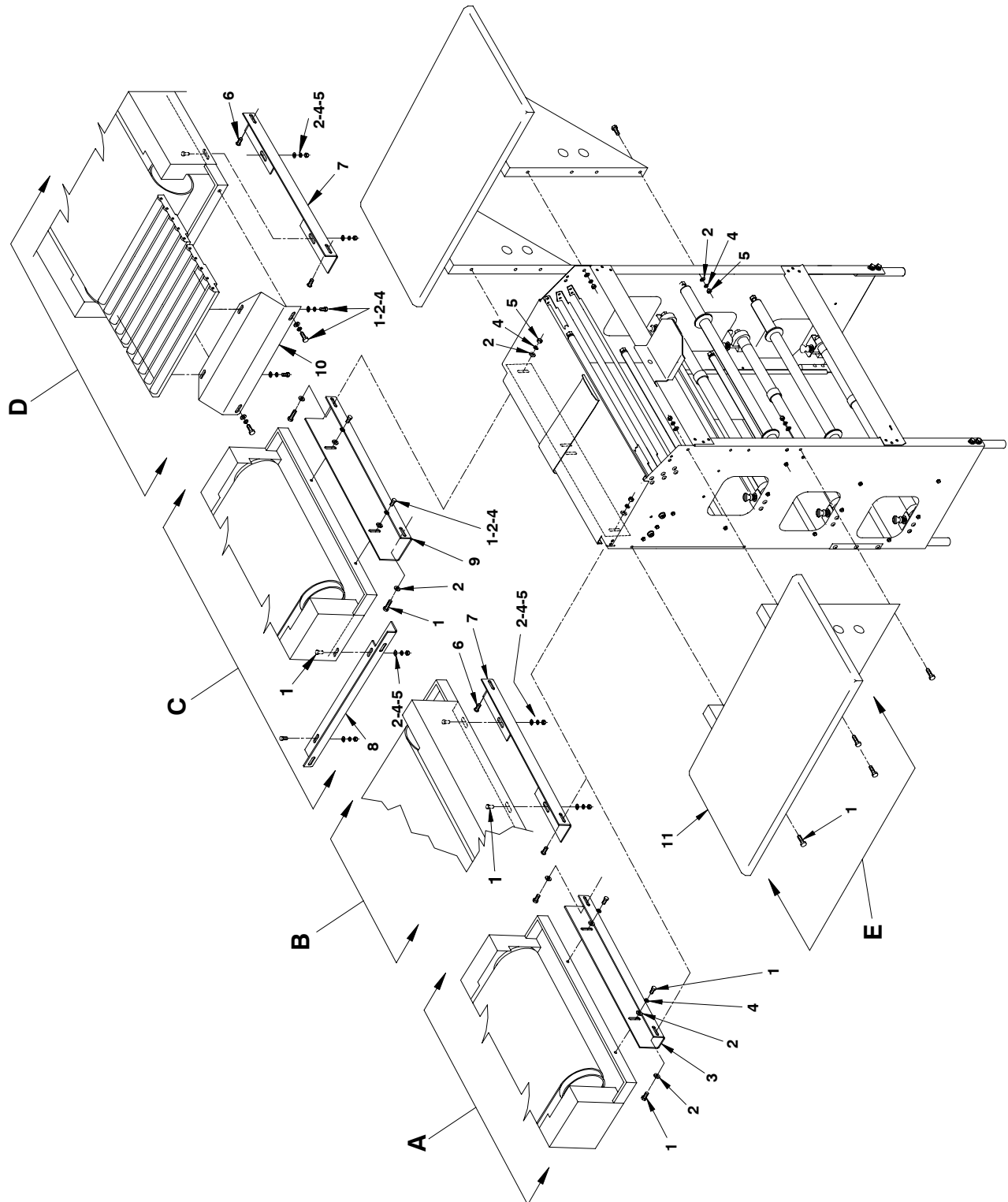

Parts List for Accessories

ITEM	DESCRIPTION	PART NUMBER
1	SCREW 1/4-20 X 1/2" HEX HEAD CAP	R0311000A
2	WASHER 1/4" FLAT	R0366300A
3	BRACKET - FRONT MOUNTING	81886300A
4	WASHER 1/4" LOCK	R0233400A
5	NUT 1/4-20 HEX	R0361400A
6	CARRIAGE BOLT 1/4-20 X 1/2"	R0364000A
7	BRACKET - SEALER SIDE MOUNT	81885400A
8	BRACKET - LEFT SIDE MOUNT	81886400A
9	BRACKET - FRONT MOUNT	81886200A
10	BRACKET - FRONT MOUNT	81886100A
11	SHELF ASSEMBLY - TRAY	82203600A
A	KIT OF PARTS TO INSTALL A 661 ON INFEED END OF BELT SEALER	0925-0138
B	KIT OF PARTS TO INSTALL A 661 ON RIGHT OR LEFT SIDE OF BELT SEALER	0925-0139
C	KIT OF PARTS TO INSTALL A 661 ON INFEED END AND LEFT SIDE OF BELT SEALER	0925-0140
D	KIT OF PARTS TO INSTALL A 661 ON INFEED END AND RIGHT SIDE OF BELT SEALER	0925-0141
E	KIT OF PARTS TO INSTALL PLATTER SHELF ON EITHER SIDE OF 661	0925-0257

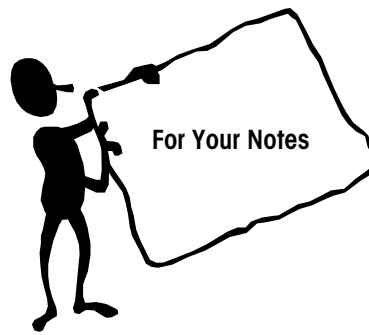

9

Wiring Diagram

TOGGLE SWITCH VERSION

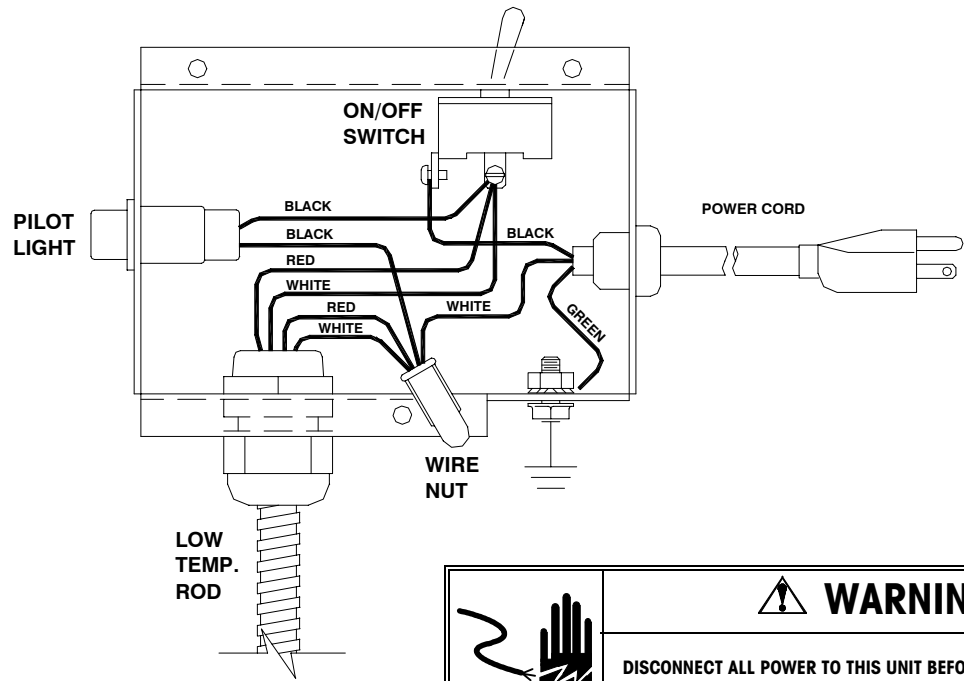

	<p>⚠ WARNING</p> <p>DISCONNECT ALL POWER TO THIS UNIT BEFORE INSTALLING, SERVICING, CLEANING, OR REMOVING THE FUSE. FAILURE TO DO SO COULD RESULT IN BODILY HARM AND/OR PROPERTY DAMAGE.</p>
--	---

ROCKER SWITCH VERSION

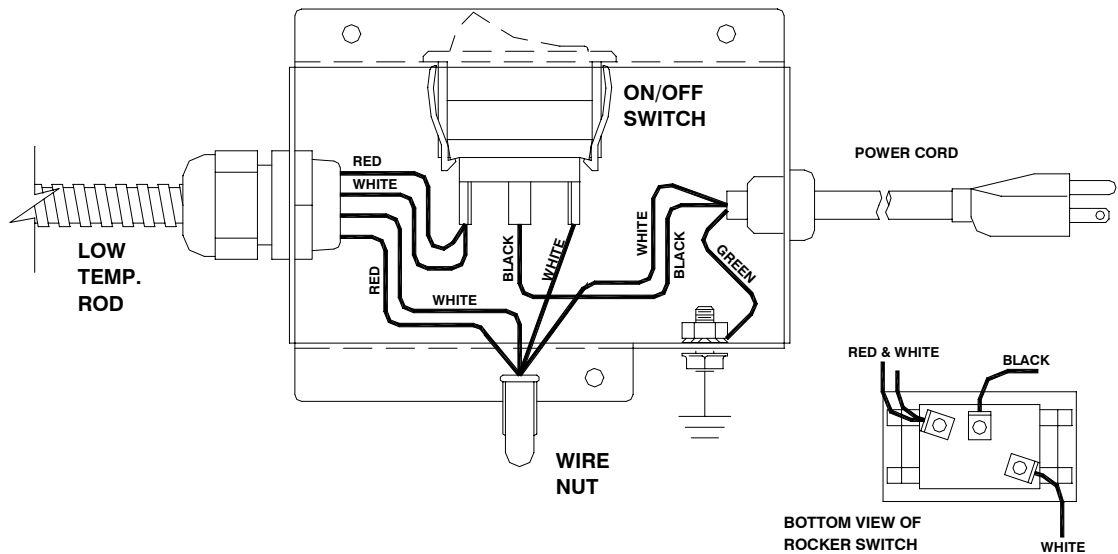

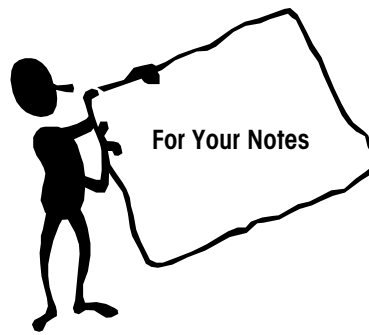

Mettler-Toledo, Inc.

1900 Polaris Parkway
Columbus, Ohio 43240
www.mt.com

P/N: 15516800A

(6/00).01

METTLER TOLEDO® is a registered Trademark of Mettler-Toledo, Inc.

©2000 Mettler-Toledo, Inc.

Printed in U.S.A.



15516800A