

Technical Bulletin

Please Distribute to all Sales and Service Personnel

Mettler-Toledo, Inc.
Scales & Systems

Number: MTFW-08-99
Date: 7-12-99
Model: 702 Bottom Label Applicator
Subject: Crushing Small Trays

A roller assembly has been released for the 702 Bottom Label Applicator. The roller assembly attaches to the side of the label guide and bridges the gap between the conveyor and the exit roller to provide additional support for small trays, which may have a tendency to flip and become jammed by the conveyor. The roller assembly will be included on all 702 Bottom Label Applicators beginning with serial number 3085048-3GA.

A service KOP 83047100A is available to add the roller assembly to existing units in the field that may be experiencing this problem. Below are the instructions for installing this KOP.

1. Remove the labels from the label guide.
2. Remove the label guide assembly by removing the 4 M4x8 mounting screws in the rear side of the label box. (See figure 1). Support the label guide assembly when removing, as the gap sensor wires will remain connected to the unit.
3. Replace the two M4x12 screws shown in figure 2 with the M4x16 screws provided.
4. Attach the applicator roller assembly to the back of the label guide by slipping it over the protruding M4x16 screws and securing it with the M4 locknuts provided as shown in figure 2.
5. Reinstall the label guide assembly in to the label box. When installed the roller should look as shown in figure 1.

Technical Bulletin

Please Distribute to all Sales and Service Personnel

Mettler-Toledo, Inc. Scales & Systems

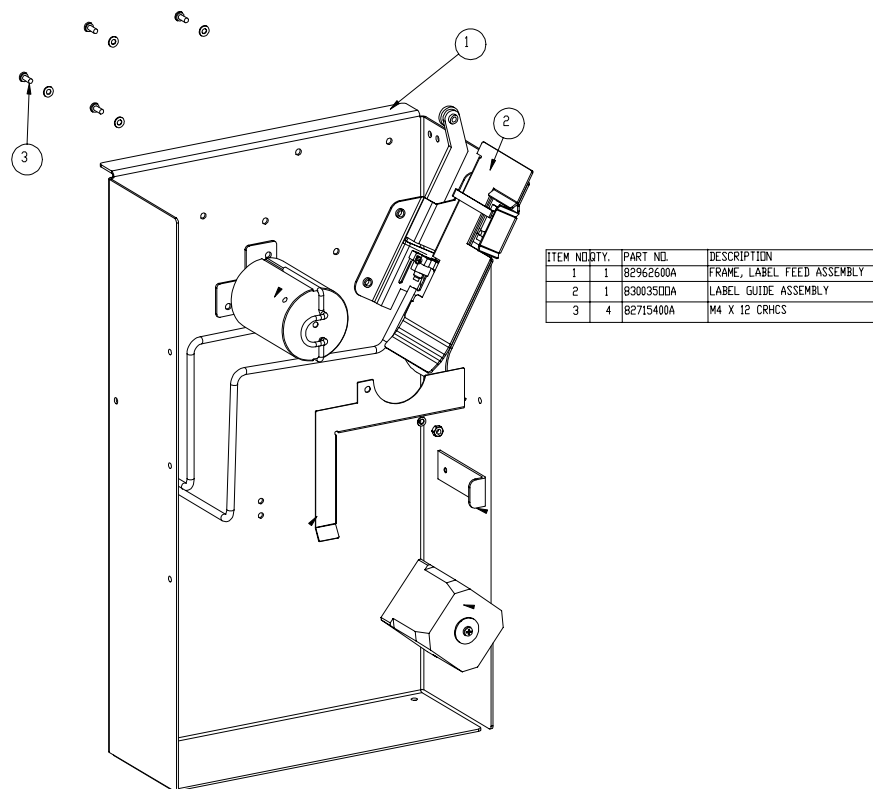

Figure 1

