

Model: 317-2001
Kit Number: 0925-0438
Description: Conversion Kit for Hobart® Labels with Modified Ticket Wheel

This kit will convert the standard Model 317 with Applicator to use standard Hobart® labels. This kit contains the following parts:

16154700A	Ticket Wheel, 2.75" core
16154800A	Label Ski Assembly, 1/2"
16154900A	Pinion Wire Lower Bracket, Narrow

To install this kit, follow these instructions.

1. Disconnect power to 317 the printer.
2. Remove any labels and spent liner from their respective spools.
3. First, remove the plastic ticket wheel. To remove the ticket wheel, slide the snap ring from the groove in the shaft, using care not to lose this retainer – they're prone to pop off and are hard to find on the floor. Next, remove the spring washer and then slide the plastic ticket wheel off of the shaft.
4. Install the new ticket wheel on the shaft. Slide the spring washer back onto the shaft and then press the snap ring into the groove in the shaft.
5. Using the Hobart® labels, adjust the label guide width per the instructions in the Model 317 Service Manual A82784900A, Label Guide and Gap Sensor Width Adjustment (page 6-16).
6. Adjust the gap sensor for the Hobart® labels per the instructions in the Model 317 Service Manual A82784900A, Label (page 6-5). Set the potentiometer using the "Mode 2" procedure.
7. Remove the label skis from the ski bracket. Retain the screws for later reuse.
8. Loosen the lock nut on the applicator head and remove the applicator head and the lock nut from the end of the pinion wire. Be careful not to damage the teeth of the pinion wire while removing these parts. Grip the pinion wire with pliers only on a section that does not normally engage the turning gear.
9. Remove the pinion wire lower bracket by removing the two screws that attach it to the applicator rod and the rack gear.
10. Install the narrow lower bracket in its place using the same fasteners. Be careful not to "torque" the moveable assembly when tightening the screws. If the applicator rod, pinion wire and rack gear are not all parallel, the applicator will not function properly.
11. Check the movement of the applicator assembly up and down to make sure it does not bind. If adjustment is necessary, hold the top pinion wire bracket in one hand and the bottom pinion wire bracket in the other and twist the assembly slightly to take out the "torque" introduced at assembly. Repeat until the applicator assembly moves up and down freely. Refer to the instructions in the Model 317 Service Manual A82784900A, Applicator Rack and Pinion Adjustment (page 6-9) for additional adjustments if necessary.
12. Replace the lock nut and the applicator head on the end of the pinion wire. Do not tighten the lock nut at this time.
13. Install the replacement skis on the ski bracket using the screws removed previously. Be careful not to over tighten the screws.
14. Adjust the applicator head per the instructions in the Model 317 Service Manual A82784900A, Applicator Head and Optical Encoder Adjustment (page 6-11).
15. Reconnect power to the Model 317 printer.
16. Install the new labels per the threading diagram.

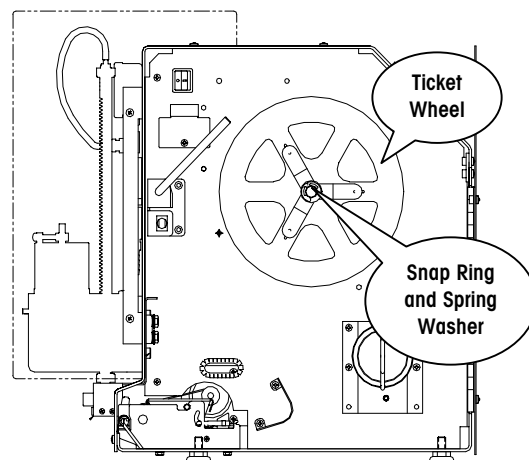

Model 317 Applicator Side View
(Cover removed)

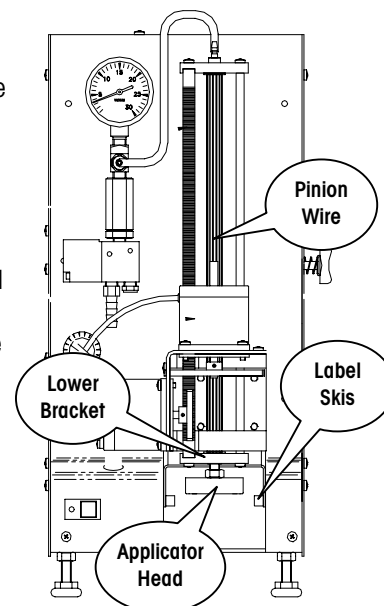

Model 317 Applicator Front View
(Cover removed)

METTLER TOLEDO
1900 Polaris Parkway
Columbus, Ohio 43240

METTLER TOLEDO® is a registered trademark of Mettler-Toledo, Inc.

©2001 Mettler-Toledo, Inc.

Printed in USA

Hobart® is a registered trademark of Hobart Corp., Dayton, OH