

# UPS SECOND DISPLAY KIT

## Kit Installation Instructions

### MAJOR COMPONENTS

1. PS60 Scale, UPS version with Display mounted to Base
2. Y-Cable with three connectors
3. Wall-mountable Remote Display with cable
4. In-line Female-to-Female Adaptor

### INSTALLATION INSTRUCTIONS

1. Remove power from the scale before taking any steps to add the second display.
2. Under the bottom of the scale, disconnect the display cable from the scale circuit board.
3. Connect the display cable into one end of the In-line female-to-female adaptor.
4. Connect the 12 inch long end of the Y-cable into the other end of the In-line adaptor.
5. Connect the 6 inch long end of the Y-cable to the scale circuit board.
6. Connect the very long end of the Y-cable into the bottom of the wall-mountable remote display.

**NOTE:** The 14-foot cable that comes with the wall-mountable remote display is not needed.

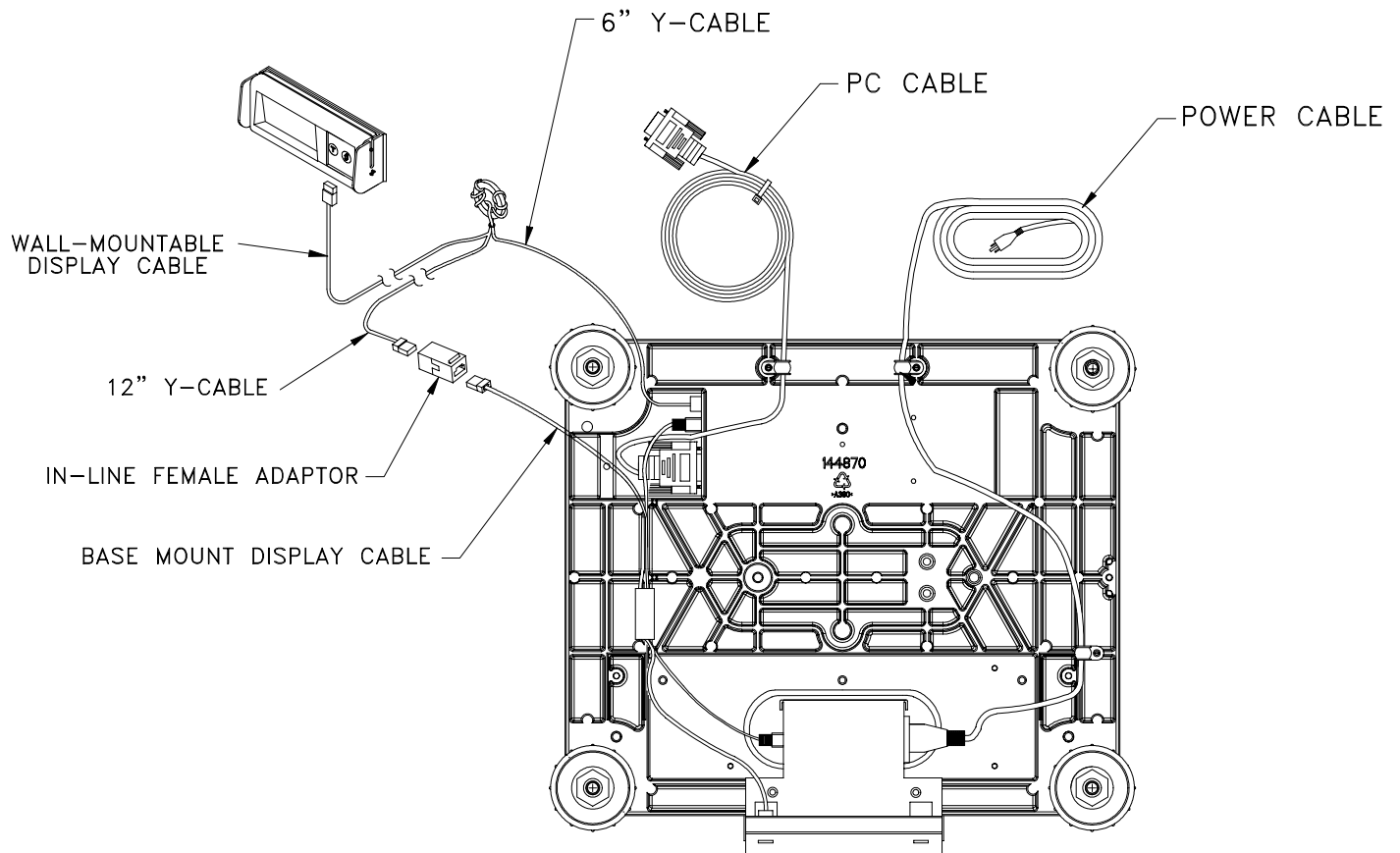

BOTTOM VIEW OF SCALE BASE



16187400A