

Panel Mount Enclosure Installation Instructions

PNs 69764, 69766, 69771, 69777, 72137, 72138

This document contains drawings, replacement parts lists, and instructions for installing wall mount models of 920i indicators. See the *920i Installation Manual*, PN 67887, for general installation and configuration and calibration information.



Warning

The 920i has no on/off switch. Before opening the unit, ensure the power cord is disconnected from the power outlet.



Caution

- Use a wrist strap to ground yourself and protect components from electrostatic discharge (ESD) when working inside the indicator enclosure.
- This unit uses double pole/neutral fusing which could create an electric shock hazard. Procedures requiring work inside the indicator must be performed by qualified service personnel only.
- The supply cord serves as the power disconnect for the 920i. The power outlet supplying the indicator must be installed near the unit and be easily accessible.

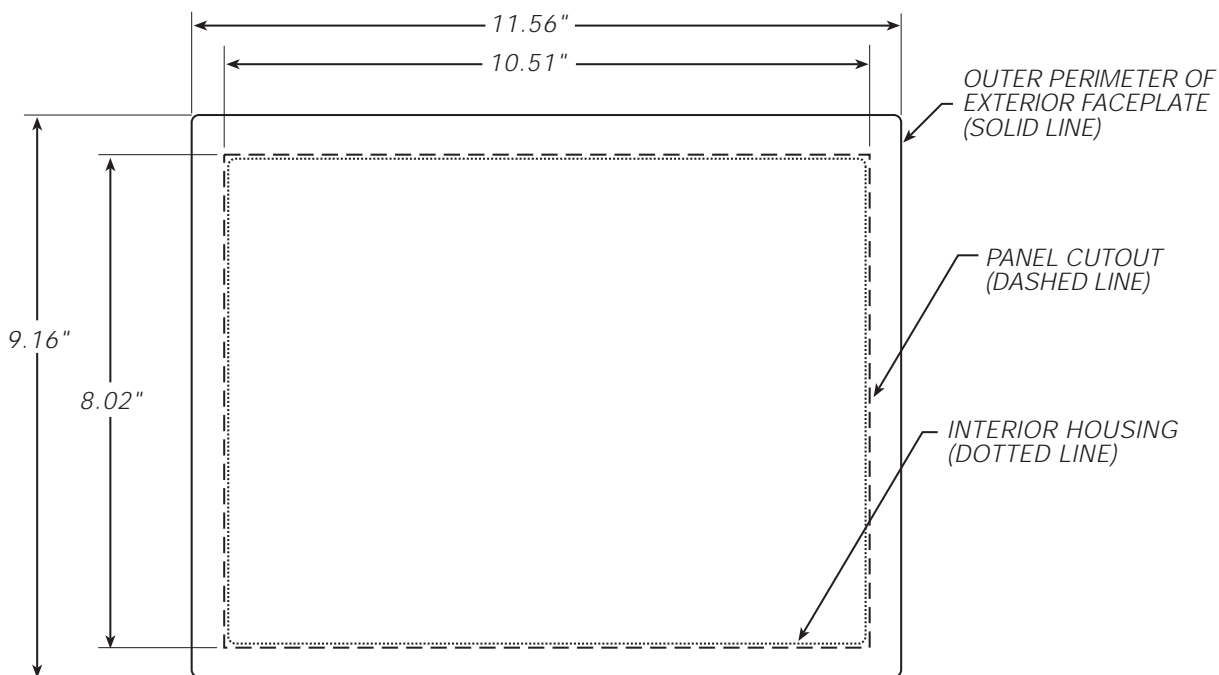

Figure 1. Panel Cutout for Panel Mount Enclosure

Installation

Use the dimensions shown in Figure 1 to lay out the panel cutout for the panel mount enclosure. See Figure 2 on page 2 for enclosure dimensions.

Once the cutout has been prepared, slide the enclosure into the cutout from the front of the panel. Slide the clinching bracket around the enclosure from inside the panel. Secure the bracket to the enclosure using the six 1/4" screws provided in the parts kit (PN 71522), then use the nine 5/8" screws (PN 71523) to secure the clinching bracket to the panel door.

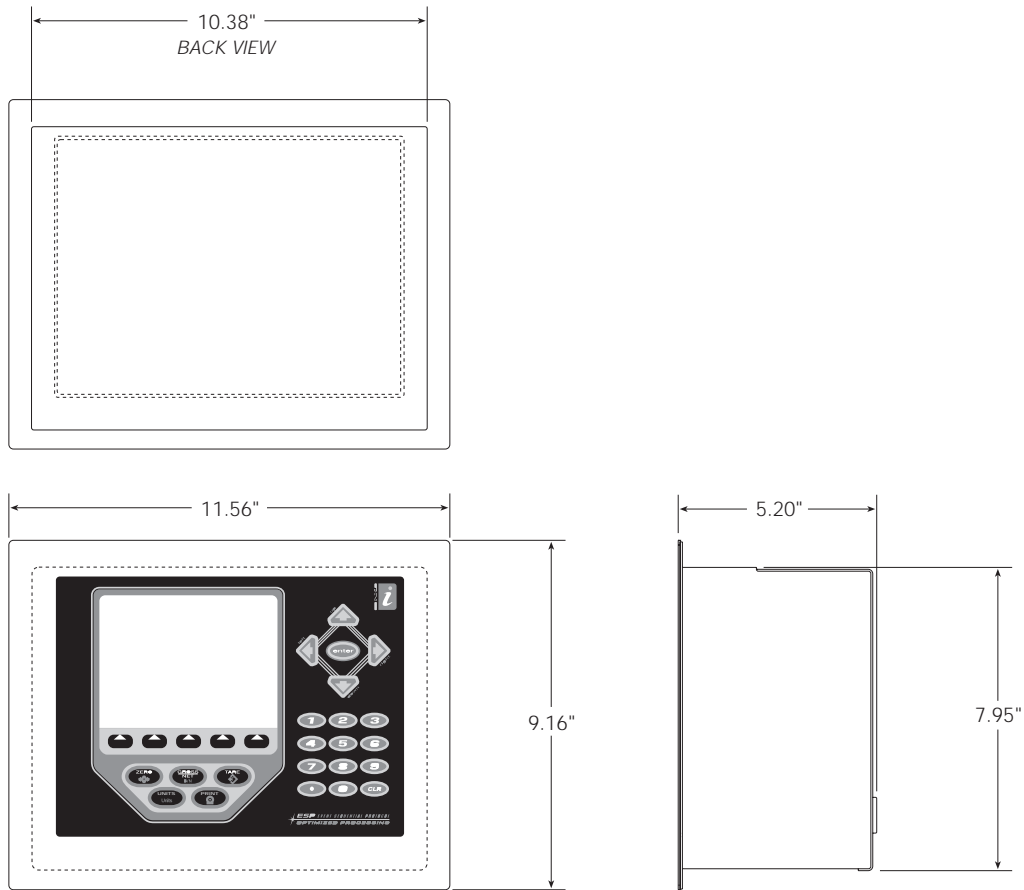

Figure 2. Panel Mount Enclosure Dimensions

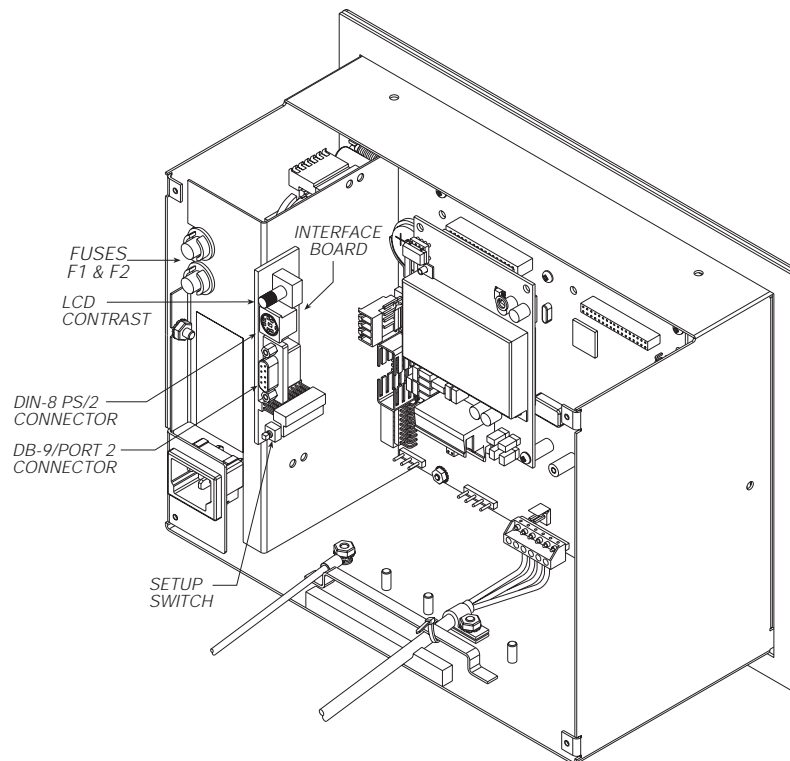

Figure 3. Panel Mount Enclosure, Interface Board and Fuse Locations

Cable Grounding

All cables routed into the panel mount enclosure should be grounded against the indicator enclosure. Do the following to ground shielded cables:

- Use the lockwashers, clamps, and keps nuts provided in the parts kit to install grounding clamps on the enclosure studs adjacent to cord grips.

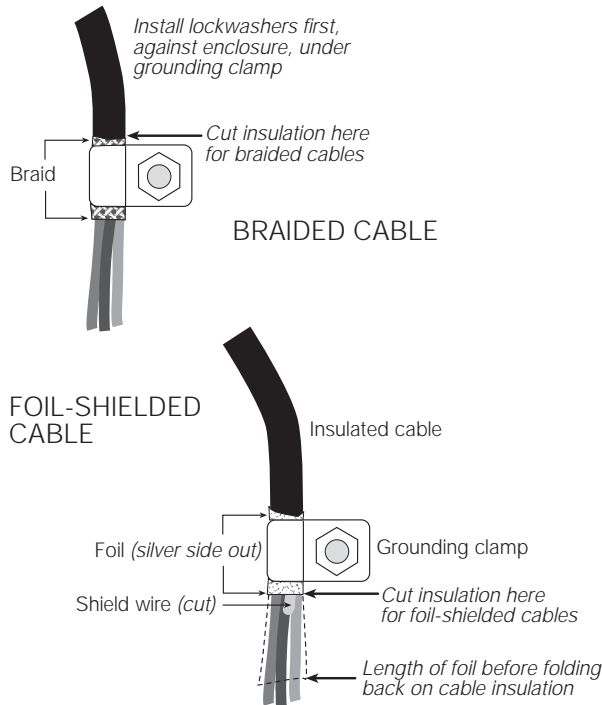

Figure 4. Grounding Clamp Attachment for Foil-Shielded and Braided Cabling

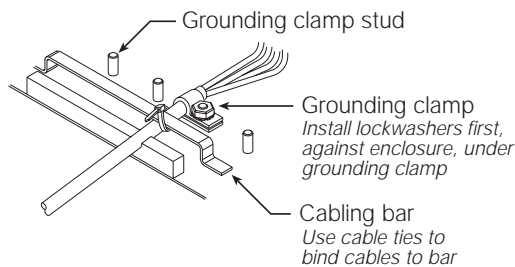

Figure 5. Cable Installation with Grounding Clamp

- Route cables under cabling bar (see Figure 5) and through grounding clamps to determine cable lengths required to reach cable connectors. Mark cables to remove insulation and shield as described below:
 - For cables with foil shielding, strip insulation and foil from the cable half an inch (15 mm) past the grounding clamp (see Figure 4). Fold the foil shield back on the cable where the cable passes through the clamp. Ensure silver (conductive) side of foil is turned outward for contact with the grounding clamp.

- For cables with braided shielding, strip cable insulation and braided shield from a point just past the grounding clamp. Strip another half inch (15 mm) of insulation *only* to expose the braid where the cable passes through the clamp.
- For load cell cables, cut the shield wire just past the grounding clamp. Shield wire function is provided by contact between the cable shield and the grounding clamp.
- Route stripped cables under cabling bar and through the clamps. Ensure shields contact grounding clamps. Tighten grounding clamp nuts.
- Use cable ties to secure cables to cabling bar.

Power Specifications

Line Voltages	115 or 230 VAC
Frequency	50 or 60 Hz
Maximum Power Consumption,	65W on secondary
Primary power consumption:	100W TRMS
Constant current:	1.5 A TRMS (115VAC); 1.0 A TRMS (230VAC)

Fusing

115 VAC and 230 VAC North American	2 x 3.15A TR5 subminiature fuses Wickmann Time-Lag 19374 Series UL Listed, CSA Certified and Approved
230 VAC European	2 x 3.15A TR5 subminiature fuses Wickmann Time-Lag 19372 Series UL Recognized, Semko and VDE Approved

See the *920i Installation Manual* for additional specifications.

Parts Kit Contents

Table 1 lists the parts kit contents for the panel mount version of the *920i*.

PN	Description
14626	Kep nuts, 8-32NC (5)
54206	Machine screws, 6-32 x 3/8 (2)
15133	Lock washers, No. 8, Type A (5)
71522	Machine screws, 8-32NC x 1/4 (6)
71523	Machine screws, 10-32NF x 5/8 (9)
15631	Cable ties (4)
53075	Cable shield ground clamps (5)
42350	Capacity label (1)
71095	Clinching bracket (1)
15887	6-position screw terminal for load cell connection (1)
70599	6-position screw terminals for J2 and J10 (2)
71126	4-position screw terminal for J9 (1)
71125	3-position screw terminal for J11 (1)

Table 1. Parts Kit Contents

Replacement Parts and Assembly Drawings

Table 2 lists replacement parts for the **920i** panel mount model, including all parts referenced in Figures 6 and 7.

Ref Number	PN	Description (Quantity)	See Figure No.
1	14618	Kep nuts, 4-40NC (2)	6
2	14626	Kep nuts, 8-32NC (4)*	
3	15601	Ground wire, 6 in w/ No. 8 eye connector (1)	
4	14822	Machine screws, 4-40NC x 1/4 (11)	
5	71450	AC input assembly (1)	
6	15134	Lock washers, No. 8, Type A (3)	
7	69898	Nylon spacers (2)	
8	16861	High voltage warning label (1)	7
9	16892	Ground/Earth label (1)	6
10	14839	Machine screws, 6-32NC x 1/4 (7)	
12	67610	Single-channel A/D card (1)	
13	67612	CPU board (1)	
14	69141	Fuse access coverplate (1)	
15	67614	LCD display (1)	
16	69142	Housing backplate (1)	
17	67869	Interface board (1)	
18	67886	Standoffs, short (4)	
20	68598	Protective lens (1)	
21	71106	Enclosure, panel mount (1)	7
22	68661	Standoffs, long (2)	6
23	70069	3V Lithium coin battery	
24	71462	Fuses F1 & F2 (115 VAC and 230 VAC North American models), 3.15 A Time-Lag TR5 (2)	7
	72339	Fuses F1 & F2 (230 VAC European model), 3.15 A Time-Lag TR5 (2)	
25	69144	Faceplate gasket (1)	6
26	67536	Power supply bracket (1)	
27	71449	Ribbon cable to interface board (1)	
28	71333	Power supply, ± 6 VDC, 65W (1)	
29	15631	Cable tie, 3-in nylon (2)*	7
30	71430	Power supply cable assembly, to CPU board (1)	
32	53308	Model/serial number label (1)	6
—	15438	Power cord, 115 VAC and 230 VAC North American units (1)	—
	72512	Power cord, 230 VAC European units (1)	
—	66502	Switch panel membrane (1)	—

* Additional parts included in parts kit.



To protect against the risk of fire, replace fuses only with same type and rating fuse.

Table 2. Replacement Parts

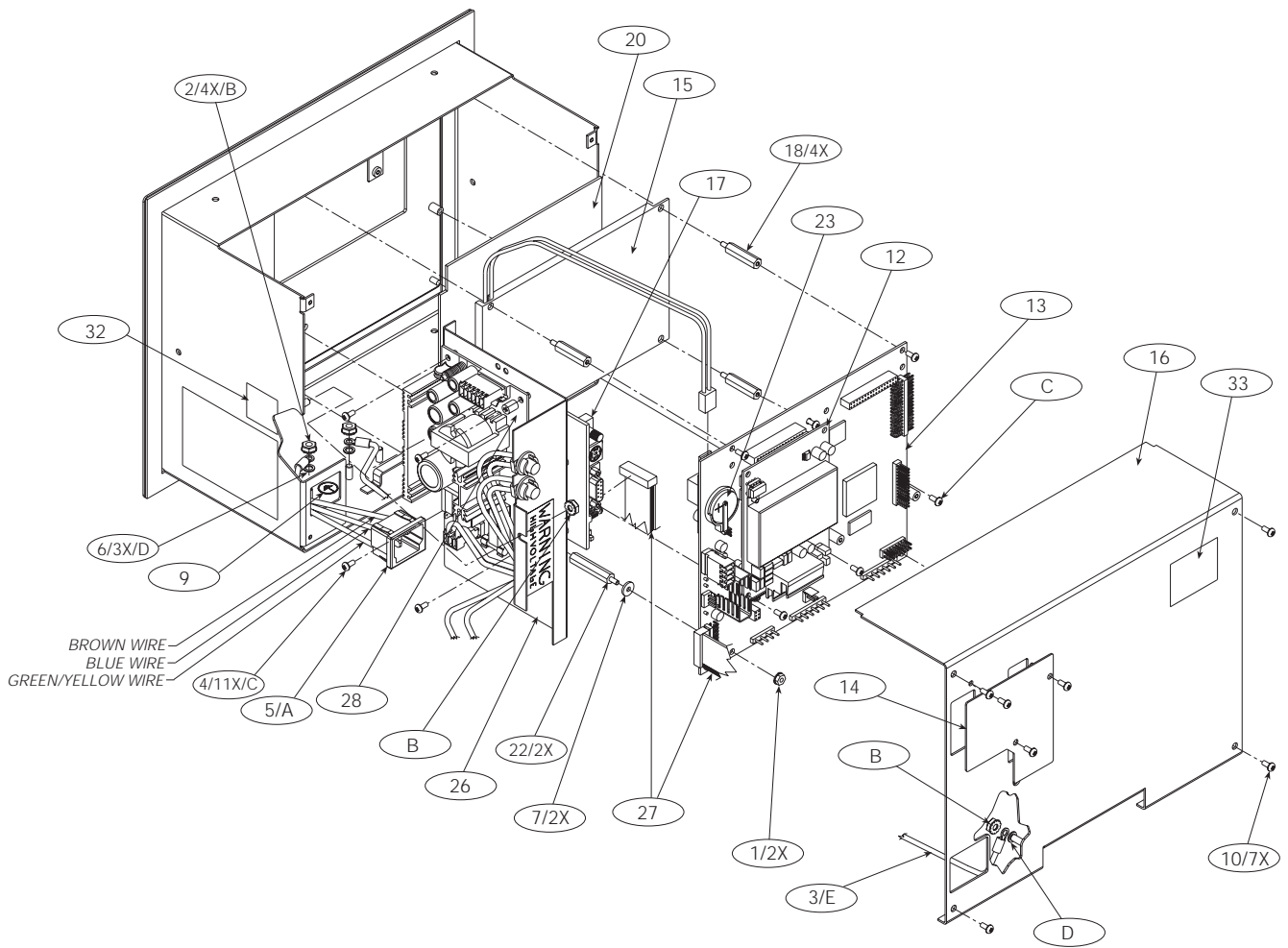

Figure 6. Panel Mount Enclosure

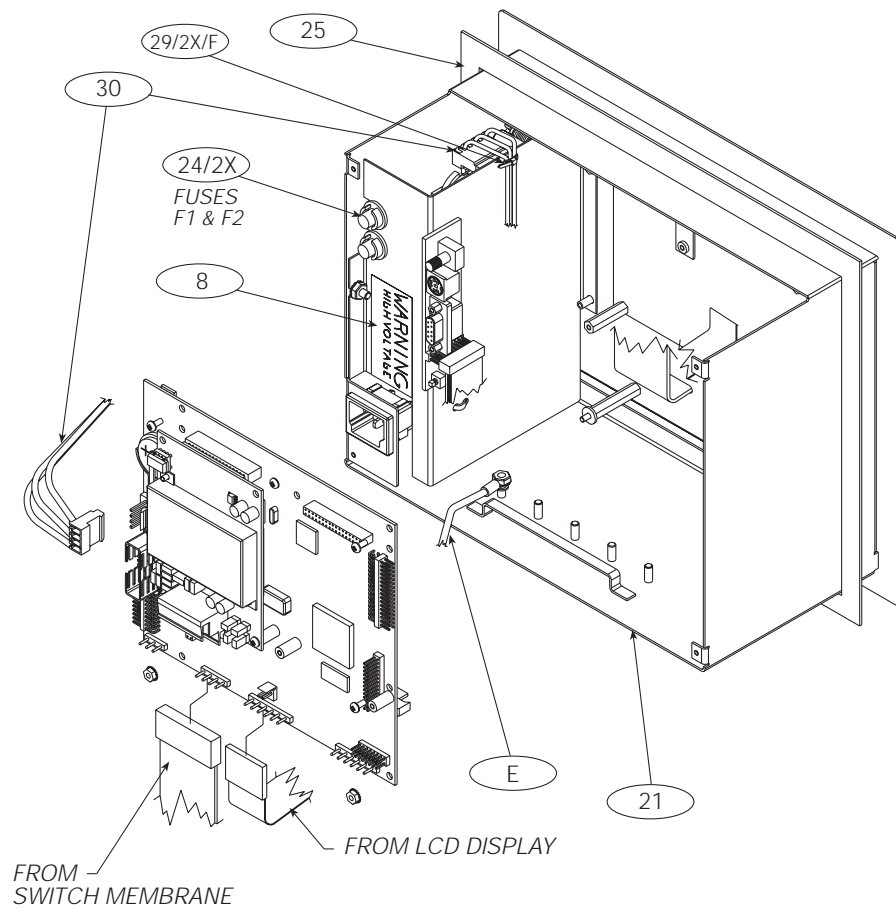

Figure 7. Panel Mount Enclosure, CPU Board Connections

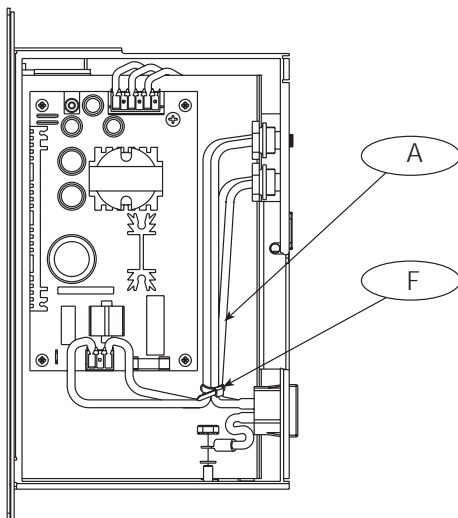

Figure 8. Panel Mount Enclosure, Power Supply Connections