

TECHtalk

A TECHNICAL PRODUCT PUBLICATION

New Stainless Steel Enclosure for IQ plus[®] 800 Indicators

This Tech Talk includes assembly drawings and parts lists for the new IQ plus[®] 800 indicator enclosure. The IQ plus 800 enclosure has been redesigned to provide easier access to internal components in a much lighter, watertight box. We expect to begin shipping the new enclosures around September 1, 1997.

The display/power supply and CPU boards are now mounted to the backplate, rather than to the front of the enclosure. For desktop models, this mounting allows removal of boards while the enclosure remains attached to the mounting bracket.



The indicator front panel connection to the display board now includes a ribbon cable extension: the ribbon cable extension must be disconnected from the front panel overlay tail before the backplate and boards

can be withdrawn from the enclosure (see *Caution!* on page 3).

Access to the IQ plus 800 setup switch has been moved from the top to the backplate of the enclosure (see #11 in Figure 1, below). Access to the setup switch is described on page 2.

The tables on the back page of this Tech Talk list the new model numbers, the IQ plus 800 parts list, and parts kit contents. Note that some reference numbers listed in the parts list may not appear on the included assembly drawings.

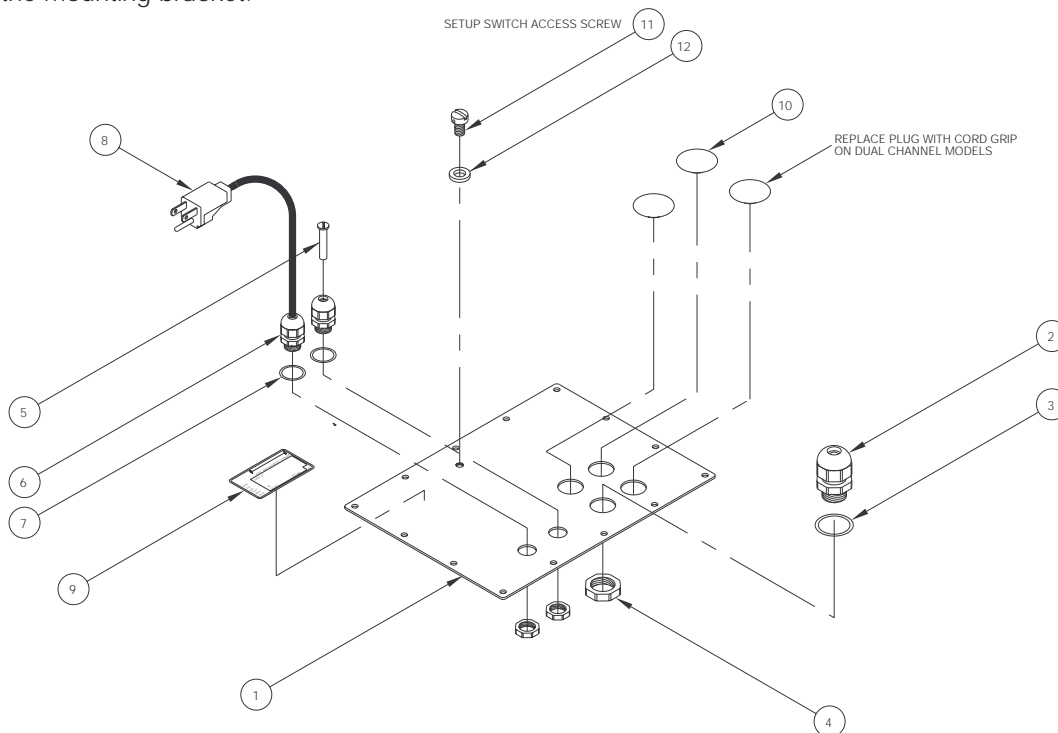

Figure 1. Backplate Assembly

RICE LAKE WEIGHING SYSTEMS
Industrial Solutions on a Global Scale[®]



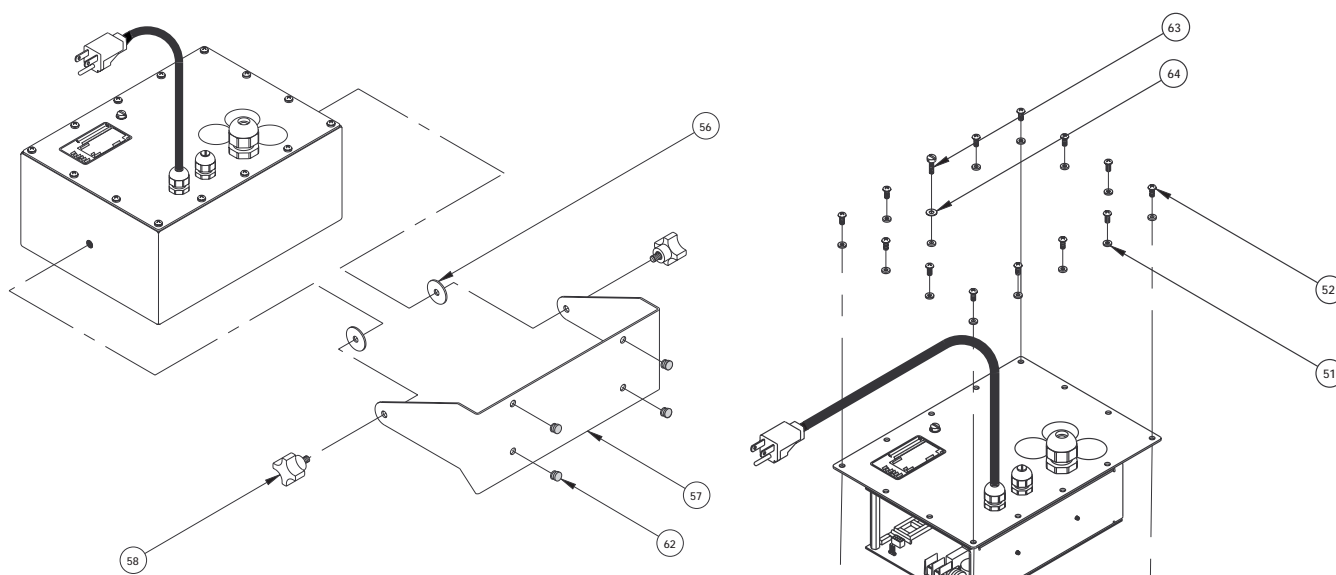

Figure 2. Tilt Stand Assembly

Setup Switch

The setup switch is accessed by removing a screw on the enclosure backplate (see #11 in Figure 1). Switch position is changed by inserting the screwdriver into the 5/16" hole and moving the switch left (CONFIGURE) or right (RUN), as indicated on the label immediately below the access hole. See Figure 3, below.

A U-shaped guard plate fitted between the backplate and the CPU board prevents accidental contact with internal components.

TO OVERLAY
EXTENSION (59)

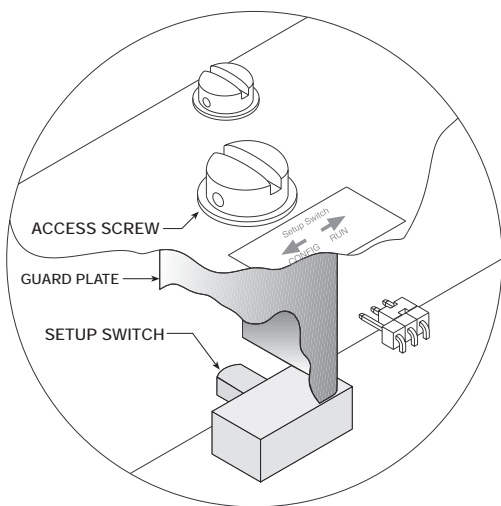

Figure 3. Setup Switch Access on Enclosure Backplate

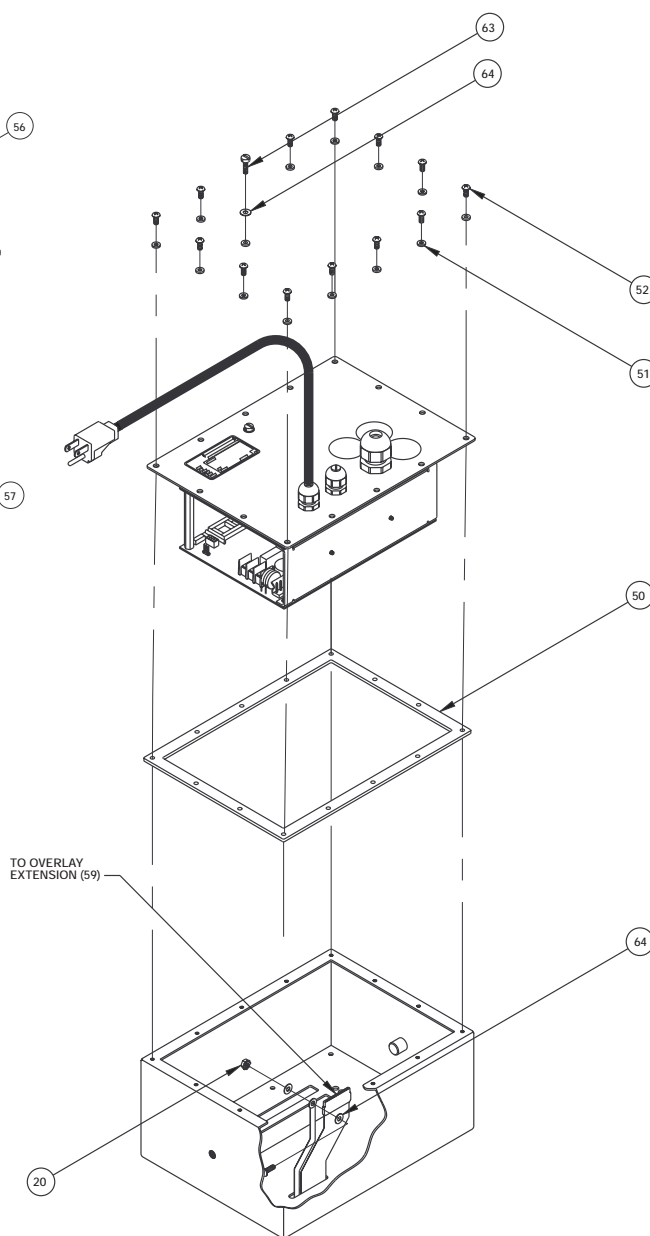

Figure 4. Enclosure/Backplate Assembly

Figure 5. Backplate/Board Set Assembly

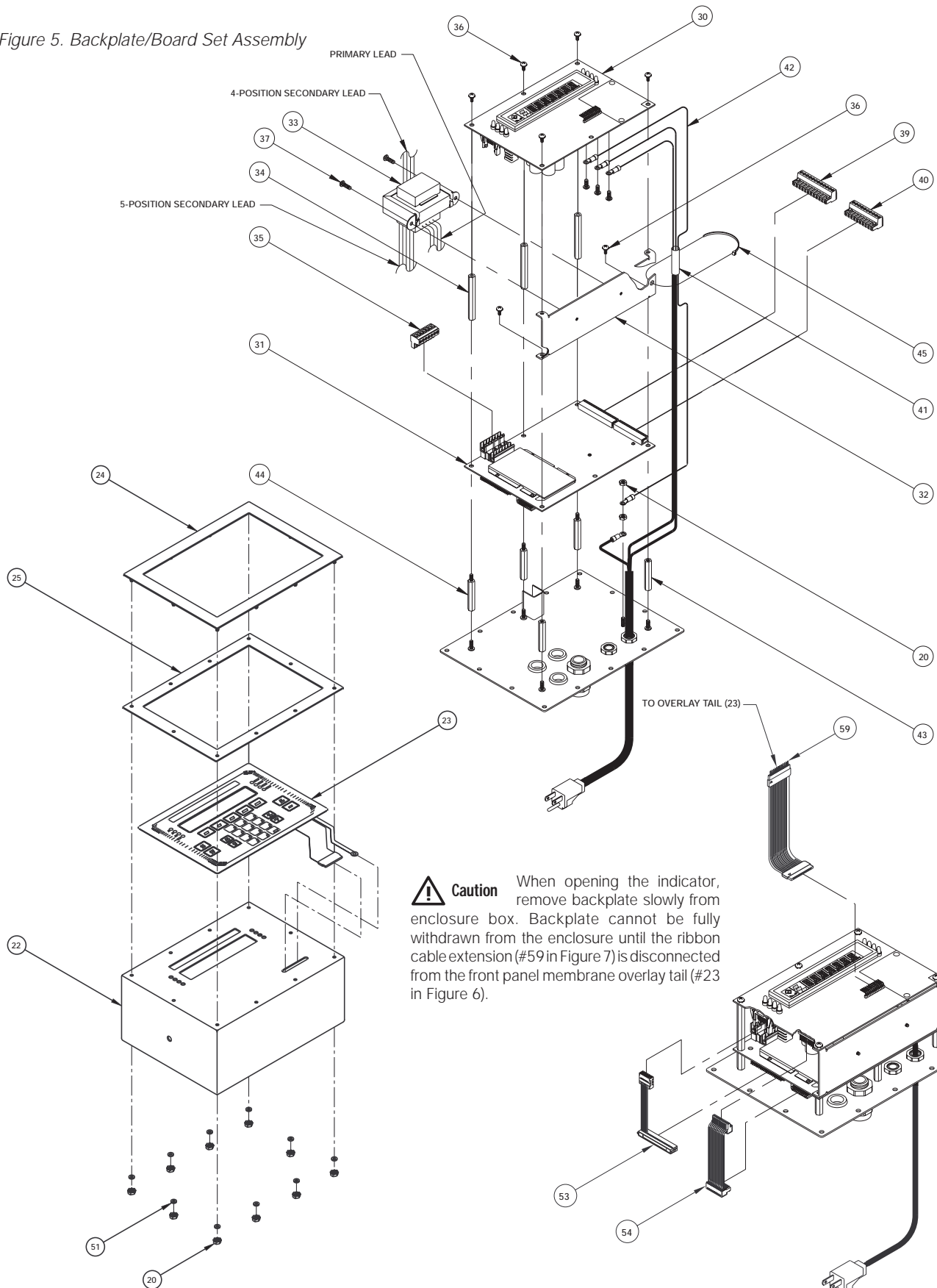

Figure 6. Enclosure/Overlay/Front Bezel Assembly

Figure 7. Display/CPU Board Connections

Ref No.	Part No.	Description	Quantity	Ref No.	Part No.	Description	Quantity
1	40939	Enclosure back plate	1	37	14857	Screw, machine 8-32NC x 1/4 phillips pan-head	2
2	15628	Cord grip, 1/2" NPT	1	39	15880	Terminal block, pluggable Phoenix 12-position	1
3	30376	Seal ring, nylon 1/2" NPT	1	40	15879	Terminal block, pluggable Phoenix 10-position	1
4	15630	Locknut, 1/2" NPT	1	41	37537	Tube, clear 3/8 x 1-1/2	1
5	19538	Plug, post screw	1	42	15601	Ground wire, 6" w/ #8 eye connector	1
6	15626	Cord grip, PG9	2	43	41574	Standoff, F-F, 8-32NC x 1-3/4 x 5/16 hex	2
7	15657	O-ring, .5 x .07 #14 PG9	2	44	41575	Standoff, M-F, 8-32NC x 1-3/4 x 5/16 hex	3
8	19645	Power cord assembly	1	45	15631	Cable tie, 3" nylon	2
9	16903	Label, model/serial number	1	50	40941	Gasket, back plate	1
10	22262	Sealing plug, 1/2" NPT	3	51	15137	Washer, neoprene .145 x .31 x 0.62	12
13	41909	Label, setup switch	1	52	14862	Screw, machine, 8-32NC x 3/8 phillips pan-head	2
20	14626	Nut, kep 8-32NC hex ext star washer	13	53	34021	Cable assembly, data, 40-pin to 10-pin	1
22	40938	Enclosure	1	54	34020	Cable assembly, power	1
23	19623	Membrane switch panel	1	55	22608	Label, A/D voltage	1
24	40940	Bezel, front	1	56	15144	Washer, nylon 1/4 x 1 x 1/16	2
25	41576	Gasket, front bezel	1	57	29635	Tilt stand	1
30	34036	Display/power supply board	1	58	30342	Knob, wing 1/4-20NC x 3/8	2
31	34035	CPU board w/ A/D	1	59	41106	Ribbon cable extension	1
32	40942	Bracket, transformer mounting	1	60	15695	Mate-N-Lok housing, 4-position	1
33	19647	Transformer	1	61	19644	3V lithium battery	1
34	41573	Standoff, F-F, 8-32NC x 2-5/8 x 5/15 hex	3	64	15138	Washer, plain #8	2
35	23165	Terminal block, pluggable Phoenix 7-position	1	65	16863	Label, scale/base	1
36	14863	Screw, machine, 8-32NC x 3/8 phillips pan-head	7	—	41280	IQ plus 800 parts kit (see <i>Parts Kit Contents</i>)	1

Table 1. IQ plus 800 Parts List

Part No.	Model
40943	IQ plus 800-3A Desktop, 115 VAC
41226	IQ plus 800-3B Desktop, 230 VAC
41227	IQ plus 800-3A Dual-Channel Desktop, 115 VAC
41228	IQ plus 800-3B Dual Channel Desktop, 230 VAC
41229	IQ plus 800x-3A Jetpak™ Desktop, 115 VAC
41230	IQ plus 800x-3B Jetpak™ Desktop, 230 VAC

Table 2. Part Numbers for IQ plus 800 Indicators

Ref No.	Part No.	Description	Quantity
11	41284	Screw, machine, 5/16-24NF x 1/4 fillister head	1
12	41892	Washer, nylon	1
51	15137	Washer, neoprene, .145 x .31 x .062	12
52	14862	Screw, machine, 8-32NC x 3/8 (11)	11
62	41909	Feet, rubber	4
63	30623	Screw, machine, 8-32NC x 7/16 fillister head	1
64	15138	Washer, plain #8 (for screw #63)	1
—	15664	Gland, reducing, 3/8" NPT	1
—	15665	Gland, reducing, 1/2" NPT	1
—	16885	Label, capacity, adhesive	1
—	30191	Label, membrane panel, adhesive	1

Table 3. IQ plus 800 Parts Kit Contents

Pass this Tech Talk along to share this technical information with your associates.

ROUTE TO:

☐
☐
☐
☐

.....

RICE LAKE WEIGHING SYSTEMS
 Industrial Solutions on a Global Scale®



Service Department
 715-234-2003

Saturdays: 8:00 a.m. – 12 noon CT
 Weekdays: 6:30 a.m. – 6:30 p.m. CT