

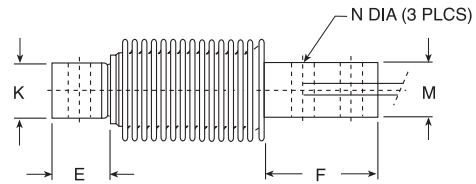

SHB Single-Ended Beam, Stainless Steel Welded Seal, IP67, NTEP 1:3000 Class III Single Cell

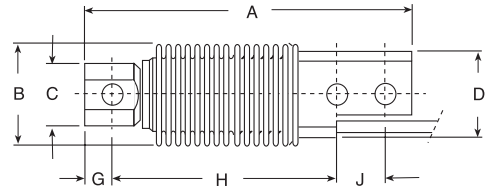

RATED CAPACITY	DIMENSIONS												
	A	B	C	D	E	F	G	H	J	K	M	N	
kg/millimeters													
20-200	120.0	38.0	22.9	31.7	21.2	42.0	10.0	82.0	18.0	20.0	20.0	8.20	
lb/inches													
44-441	4.72	1.50	.90	1.28	.83	1.65	.39	3.23	.71	.79	.79	.32	

SPECIFICATIONS:

Full Scale Output: 2.0 mV/V
Bridge Resistance: 350 ohms, nominal
Material/Finish: Stainless steel
Temperature: Compensated range
 14°F to 104°F/-10°C to 40° C
Manufacturer Model Number: SHB-A3-XX-10P5
Safe Overload: 150% Full scale
Rated Excitation: 10V DC (15V maximum)
Combined Error: 0.03% Full scale (SHB-D3)
 0.02% Full scale (SHB-A3)

Non-repeatability: 0.01% Full scale
Insulation Resistance: 5000 megohms
Deflection at Capacity: 20-200 kg = .4mm/.015"
Seal Type: Welded seal, IP67
Cable Length: 3m/10'
Cable Color Code: Green + Excitation
 Black - Excitation
 White + Signal
 Red - Signal
 Clear Shield
Warranty: 3 years

SHB ORDER INFORMATION

Load Rating	Part #	Suggested List Price
NTEP 1:3000:		
20 kg (44.1 lb)	28801	\$430.00
50 kg (110.2 lb)	28802	\$430.00
100 kg (220.5 lb)	28803	\$430.00
200 kg (440.9 lb)	28804	\$430.00

INTERCHANGEABLE PRODUCTS

Manufacturer	Model
Rice Lake Weighing Systems	(see page 123) RLHBB
HBM	(see page 222) Z6
Tedea-Huntleigh	(see page 310) 355