

LOC Single Point, Aluminum, Heavy Capacity NTEP 1:5000 Class III Single Cell

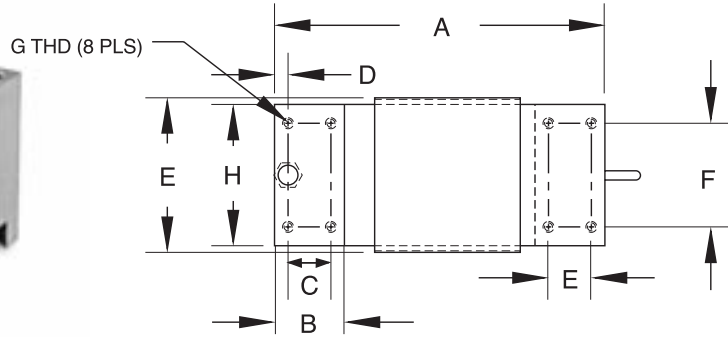

RATED CAPACITY	DIMENSIONS							
	A	B	C	D	E	F	G	H
kg/millimeters 100 - 500	191.0	-	25.0	11.0	82.0	60.0	5/16-18UNC X 20 DP	75.0
lb/inches 220.5 -1102.5	7.52	-	.98	.31	3.23	2.36	5/16-18UNC X 0.59 DP	2.95

SPECIFICATIONS:

Full Scale Output:	2.0 mV/V	Insulation Resistance:	5000 megohms
Bridge Resistance:	350 ohms, nominal	Seal Type:	Environmentally protected
Material/Finish:	Aluminum	Cable Length:	100 kg = 1m/3.3' 150-500 kg & 100 -500 kg = 2m/6.6'
Temperature:	Compensated temperature range 14°F to 104°F/-10°C to 40°C	Cable Color Code:	Green ... + Excitation Black - Excitation Blue + Sense Brown ... - Sense Red + Signal White - Signal
Safe Overload:	150% Full scale	Warranty:	1 year
Rated Excitation:	10V DC (15V maximum)		
Combined Error:	0.025% Full scale		
Non-Repeatability:	0.02%		

LOC ORDER INFORMATION

Load Rating	Part #	Suggested List Price
100 kg (220.5 lb)	39797	\$295.00
150 kg (330.7 lb)	39796	\$295.00
250 kg (551.2 lb)	39795	\$295.00
300 kg (661.4 lb)	39794	\$295.00
500 kg (1102.3 lb)	39793	\$295.00

INTERCHANGEABLE PRODUCTS

Manufacturer	Model
Rice Lake Weighing Systems	(see page 154) RL1250
Tedea-Huntleigh	(see page 322) 1250
Revere	(see page 261) 652
Flintec	(see page 205) PCB