

## RD-232 Remote Display



PART #	DESCRIPTION
32716	RD-232, 115 VAC/12 VDC, FRP enclosure
32717	RD-232, 115 VAC/12 VDC, stainless steel enclosure
32727	RD-232, 115 VAC/12 VDC, panel mount
34748	RD-232, 230 VAC/12 VDC, FRP enclosure

Featuring a NEMA 4X Fiberglass-Reinforced Polyester (FRP) enclosure, the RD-232 remote display is built to withstand the rigors of harsh treatment in wet and corrosive environments.

With a highly-visible .8" LED display and its full array of features, including a range of selectable interfaces, selectable baud rates, and annunciators, the RD-232 is ideal for truck, chemical, agricultural and paper applications. In food processing environments, the optional stainless steel enclosure provides maximum protection. A panel-mount version is also available.

Standard RS-232 or 20 mA current loop allows interfacing to a range of host devices. In applications requiring cable lengths in excess of 500 feet, the RD-232 actually pays for itself in cable savings when compared to parallel displays. Installation of the RD-232 is easy, requiring only two wire connections and a 115 VAC outlet or 12 VDC power supply.

### Applications

- Hostile washdown applications
- Corrosive environments
- Harsh industrial areas
- Wet and humid areas
- Indoor/outdoor use

### Standard Features

- NEMA 4X Fiberglass-Reinforced Polyester (FRP) wall-mount enclosure
- Easy-to-read 6-digit 0.8" (20.3mm) Light Emitting Diode (LED)
- AC or DC operation
- 4 status annunciators
- Full floating decimal point
- RS-232 or 20 mA current loop active or passive interface
- Optional NEMA 4X stainless steel wall-mount enclosure or NEMA 12 panel-mount version
- Compatible with a variety of digital weighing indicators; DIP switch selectable intuitive data receiver interprets serial strings

### Options/Accessories

- 33210 ..... Additional operating manual (RD-300/RD-232)



RD-232 NEMA 4X stainless steel wall mount enclosure

**DISPLAY:**

6-digit, 7-segment, 0.8" (20.32 mm) Light Emitting Diode (LED)

**STATUS ANNUNCIATORS:**

lb, kg, gross, net

**OPERATING VOLTAGE:**

115 VAC/12 VDC, ±10% 60Hz, 230 VAC available  
DC Voltage Range: 6.2-18 VDC

**INPUT INTERFACE:**

RS-232, 20 mA active or passive current loop, standard  
ASCII compatible

**BAUD RATE:**

Selectable: 300, 600, 1200, 2400, 4800, 9600, 19,200

**OPERATING TEMPERATURE:**

-13°F to 104°F (-25°C to 40°C)

**RATING/MATERIAL:**

NEMA 4X FRP or optional stainless steel

**WEIGHT:**

Approximately 5 lb (2.3 kg)  
Stainless steel unit, approximately 6 lb (2.7 kg)

**WARRANTY:**

One year limited warranty

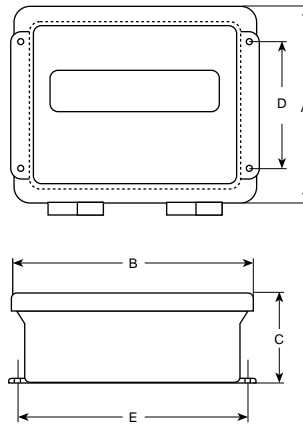

**DIMENSIONS**

FRP Enclosure	Stainless Steel Enclosure
A = 8.00" (203.2mm)	A = 6.00" (152.4mm)
B = 9.50" (241.3mm)	B = 9.50" (241.3mm)
C = 5.25" (133.4mm)	C = 3.87" (98.3mm)
D = 4.00" (101.6mm)	D = 4.00" (101.6mm)
E = 8.75" (222.3mm)	E = 8.75" (222.3mm)